

Rodejohann



Sonderwerkzeugbau und
Werkzeugschleiferei GmbH

HW-Wendeplatten 2006



Hartmetallsorten und ihre Anwendungen











In der modernen Hartmetall-Technologie werden die Hartmetalle nach Korngrößen und Bindergehalt klassifiziert (im Namen enthalten).

Abkürzung	Erklärung	Korngröße
NG	N ano G rain	0.2
UMG	U ltra M icro G rain	0.2 – 0.5
SMG	S ub M icro G rain	0.5 – 0.7
MG	M icro G rain	0.7 – 1.0
F	F ine G rain	1.0 – 1.4
MF	M edium F ine Grain	1.4 – 2.5
M	M edium Grain	2.5 – 4.0
C	C oarse Grain	4.0 – 10.0
EC	E xtra C oarse	10

Technische Daten

Sorte	US Code	ISO-Code	Binder %	Härte (HV 10)	Biegebruchfestigkeit (N/mm ²)
T02SMG			2.5	2300	2000
T03SMG		K01	3.0	2150	2400
T04F	C4	K05	4.0	1750	2350
T06M			6.0	1350	2400
T06MF	C3	K20	6.0	1600	2200
T08MF	C2	K30	8.0	1450	2500
T08SMG			8.0	1800	3300
T10MF	C1	K40	10.0	1400	2600
T10MG			10.0	1650	3600
TL15			15.0	1400	3800
TL20			20.0	1400	3200

Hartmetallsorten und ihre Anwendung

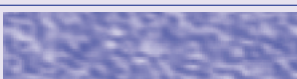
Struktur 1 : 5000	Sorte	MDF	Spanplatte	Hartholz	Weichholz	Verleimholz
	T02SMG	+++	++	-	--	--
	T03SMG	+++	+++	o	--	-
	T04F	+	++	+	+	+
	T06M	--	-	o	o	o
	T06MF	o	o	+	+	+
	T08MF	--	-	+	+	o
	T08SMG	o	+	++	+	++
	T10MF	--	--	o	+	o
	T10MG	o	o	++	++	+
	TL15	--	--	++	+++	+
	TL20	--	--	++	+++	+
+++ Hervorragend + Gut - Weniger gut ++ Sehr gut o Akzeptabel -- Schlecht geeignet						

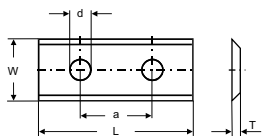

Standard Wendeschneidplatten 35°

L mm	W mm	T mm	a mm		T04F	€/Stk	T03SMG	€/Stk	T10MG	€/Stk	TL15	€/Stk	T08SMG	€/Stk
7.5	12.0	1.5		35°	10.12001	1,75	10.13811	2,40	10.13963	2,40	10.13734	2,50	10.14225	2,65
8.6	12.0	1.5		35°	10.13182	2,95								
9.0	12.0	1.5		35°	10.12043	2,10								
9.6	12.0	1.5		35°	10.12015	2,75	10.13850	3,15	10.14010	2,10	10.30833	3,20		
10.0	12.0	1.5		35°	10.13165	3,20								
10.5	12.0	1.5		35°	10.13167	3,30								
11.0	12.0	1.5		35°	10.13168	3,30								
11.6	12.0	1.5		35°	10.13183	2,20								
13.0	12.0	1.5		35°	10.13170	3,40								
13.6	12.0	1.5		35°	10.13185	3,40								
14.6	12.0	1.5		35°	10.13186	3,30								
15.0	12.0	1.5		35°	10.12003	1,91	10.13819	2,50	10.13972	2,45	10.13741	2,60	10.14232	2,95
15.7	12.0	1.5		35°	10.13172	3,50								
16.0	12.0	1.5		35°	10.13203	3,40								
17.0	12.0	1.5		35°	10.13173	3,50								
18.0	12.0	1.5		35°	10.13174	3,40								
19.0	12.0	1.5		35°	10.13175	3,40								
20.0	12.0	1.5		35°	10.12004	1,68	10.13823	2,60	10.13977	2,60	10.13745	2,70	10.14235	2,80
25.0	12.0	1.5		35°	10.12025	2,10	10.13853	3,30	10.14013	3,30	10.13766	3,40		
25.0	12.0	1.5	14.0	35°	10.12011	2,30	10.13843	3,30	10.14001	3,30	10.13759	3,40		
30.0	12.0	1.5	14.0	35°	10.12005	1,78	10.13828	2,80	10.13982	2,80	10.13749	3,95	10.14239	3,05
35.0	12.0	1.5	26.0	35°	10.13208	3,60								
40.0	12.0	1.5	26.0	35°	10.12014	2,91	10.13847	3,40	10.14006	3,40	10.13763	3,50	10.14255	3,65
50.0	12.0	1.5	26.0	35°	10.12006	2,50	10.13834	3,40	10.13987	3,40	10.13753	3,50	10.14244	3,65
60.0	12.0	1.5	26.0	35°	10.12007	4,50	10.13839	4,70	10.13994	4,60	10.13754	4,80	10.14248	4,95

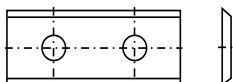

L mm	W mm	T mm	a mm		T08MF	€/Stk	T03SMG	€/Stk	T10MG	€/Stk	TL15	€/Stk	T08SMG	€/Stk
80.0	13.0	2.2	60.0	35°	10.12008	8,65	10.13841	14,75	10.13997	14,75	10.13755	15,85		
100.0	13.0	2.2	60.0	35°	10.12009	11,80	10.30831	13,90	10.13998	13,90	10.13756	14,10		
120.0	13.0	2.2	60.0	35°	10.12010	13,90	10.30832	19,60	10.13999	19,60	10.13757	23,75		

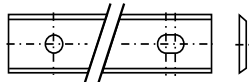

L mm	W mm	T mm	a mm		T04F	€/Stk	T03SMG	€/Stk	T10MG	€/Stk	TL15	€/Stk	T08SMG	€/Stk
20.0	9.0	1.5		35°	10.13195	3,15								
24.0	9.0	1.5	14.0	35°	10.13197	3,75								
30.0	9.0	1.5	14.0	35°	10.13199	3,80								
40.0	9.0	1.5	26.0	35°	10.13200	4,75								
50.0	9.0	1.5	26.0	35°	10.13201	4,75								

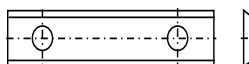
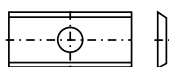

Andere Abmessungen auf Anfrage

Unverbindliche Preisempfehlung · Alle Preise verstehen sich als Verkaufspreise zuzüglich der aktuellen gesetzlichen Mehrwertsteuer · Änderungen vorbehalten

Standard Wendeschneidplatten

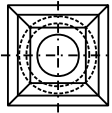
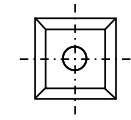
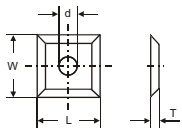

L mm	W mm	T mm	d mm		T08MF	€/Stk	T04F	€/Stk	T03SMG	€/Stk	T10MG	€/Stk	TL15	€/Stk
10.5	10.5	1.5	35°	4.0			10.13259	2,75	10.13863	2,95	10.14027	2,95	10.13769	3,15
12.0	12.0	1.5	35°	4.0			10.12002	1,45	10.13815	2,75	10.13968	2,75	10.13737	2,95
13.0	13.0	2.5	35°	4.0	10.13328	3,40								
17.0	17.0	2.0	35°	3.0	10.16565	3,95	10.16564	4,45						
17.0	17.0	2.0	35°	4.0	10.13266	3,95	10.13265	4,45	10.13864	5,60	10.30830	5,60	10.13770	5,80
19.0	19.0	2.0	35°	4.0			10.13264	4,90	10.30838	6,15	10.30827	6,15	10.30826	6,45
10.5	10.5	1.5	35°										10.40343	2,25
13.0	13.0	2.5	30°		10.13324	3,40								
13.6	13.6	2.0	30°		10.13299	1,60								
13.6	13.6	2.0	45°		10.37522	2,50								
14.0	14.0	1.2	30°		10.13295	1,65								
14.0	14.0	1.7	22°		10.13297	3,20								
14.0	14.0	1.7	30°		10.13307	3,20								
14.0	14.0	2.0	30°		10.13273	1,30	10.13260	1,80	10.13865	1,90	10.14028	1,80	10.13771	1,90
14.0	14.0	1.2	30°		10.13303	1,70								
14.3	14.3	2.5	35°								10.13329	3,50		
14.6	14.6	2.5	30°	R = 50							10.13314	3,70		
15.0	15.0	2.5	30°	R = 150							10.13315	3,70		
14.0	14.0	2.0	30°		10.13276	3,70								
15.0	15.0	2.5	30°								10.13320	4,20		
15.0	15.0	2.5	6.0								10.44289	4,10		
14.0	14.0	2.0			10.44486	2,75								
21.0	21.0	5.5									10.22695	8,40		

Andere Abmessungen auf Anfrage

Unverbindliche Preisempfehlung · Alle Preise verstehen sich als Verkaufspreise zuzüglich der aktuellen gesetzlichen Mehrwertsteuer · Änderungen vorbehalten

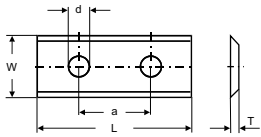

Vorschneider, Nuter

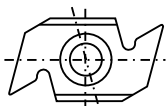
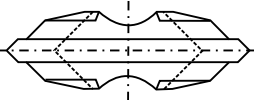
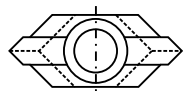
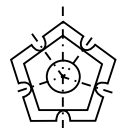
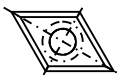
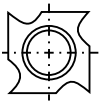

L mm	W mm	T mm	d mm		T08MF €/Stk	T06MF €/Stk	T10MG €/Stk
14.0	14.0	2.00			10.13237	4,85	
18.0	18.0	1.95			10.13293	4,00	
18.0	18.0	2.45			10.13291	4,75	
18.0	18.0	2.95			10.13305	6,35	
18.0	18.0	3.70			10.13289	8,10	
22.9	19.8	2.5	30°		10.45180	3,95	
22.0	19.0	2.0	30°		10.13271	3,35	
14.0	14.0	2.0	30°		10.13258	4,85	
16.0	16.0	3.0	32°		10.30829	8,10	
18.5		3.25	30°				10.17190
33.5			2.5		10.13252	8,25	
18.9	7.9	4.0			10.13253	8,10	
18.0	5.7	3.5			10.13255	8,10	
34.0	16.0	4.0				10.13278	13,25
34.0	16.0	5.0				10.13279	13,75
34.0	16.0	6.0				10.13280	14,50
34.0	16.0	7.0				10.13281	18,30

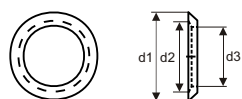
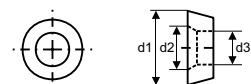

d1 mm	d2 mm	d3 mm	T mm		T06MF €/Stk	T03SMG €/Stk
11.0	7.0	5.1	4.0			10.13373
56.5	46.5	42.5	3.0		10.13370	50,15

Andere Abmessungen auf Anfrage

Unverbindliche Preisempfehlung · Alle Preise verstehen sich als Verkaufspreise zuzüglich der aktuellen gesetzlichen Mehrwertsteuer · Änderungen vorbehalten

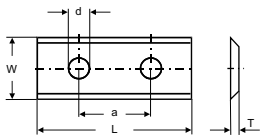

Standard Wendeschneidplatten 35°

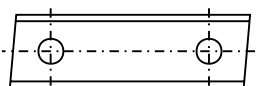
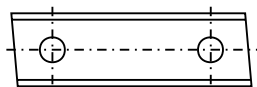
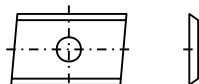
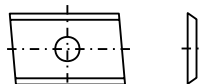
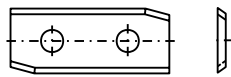
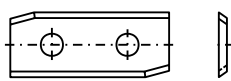
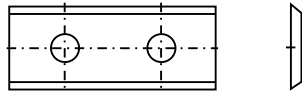
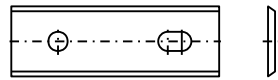
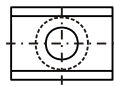

L mm	W mm	T mm	d mm		T04F €/Stk	T03SMG €/Stk	T10MG €/Stk
20.0	14.3	2.5	35°		10.13730 4,80	10.33492 5,20	10.33491 5,60
44.5	15.0	1.5	35°	25.0	10.13447 5,40		
30.0	12.0	1.5	35°	16.0	10.13449 3,75	10.33490 4,35	10.33477 4,35
30.0	12.0	1.5	35°	14.0	10.13430 3,90	10.13924 4,45	10.33466 4,40
50.0	12.0	1.5	35°	26.0	10.13432 5,20	10.33470 5,60	10.33468 5,50
30.0	12.0	1.5	35°	14.0	10.13431 3,90	10.13925 4,45	10.33467 4,40
50.0	12.0	1.5	35°	26.0	10.13433 5,20	10.33471 5,60	10.33469 5,50
20.0	12.0	1.5	35°		10.13436 3,40	10.33480 3,90	10.33479 3,90
20.0	12.0	1.5	35°		10.13441 3,40	10.33481 3,90	10.33482 3,90
30.0	12.0	1.5	35°	14.0	10.13437 3,75	10.13926 3,95	10.33489 3,90
40.0	12.0	1.5	35°	26.0	10.13440 4,10		
50.0	12.0	1.5	35°	26.0	10.13438 4,10	10.13927 4,40	10.14038 4,40
30.0	12.0	1.5	35°	14.0	10.13442 3,75	10.13928 3,95	10.33484 3,90
40.0	12.0	1.5	35°	26.0	10.13445 4,10		
50.0	12.0	1.5	35°	26.0	10.13443 4,10	10.13929 4,40	10.14039 4,40

Andere Abmessungen auf Anfrage

Unverbindliche Preisempfehlung · Alle Preise verstehen sich als Verkaufspreise zuzüglich der aktuellen gesetzlichen Mehrwertsteuer · Änderungen vorbehalten

Standard Wendeschneidplatten 45° mit 4 Schneidkanten

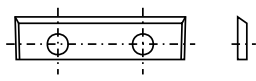
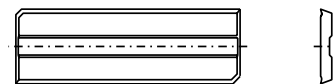
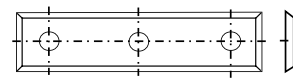
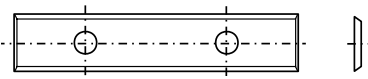
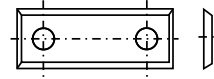
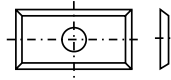
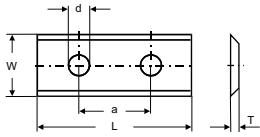

L mm	W mm	T mm	a mm	T04F €/Stk	T03SMG €/Stk	T10MG €/Stk	TL15 €/Stk
19.5	7.0	1.5	45°	10.13492	4,20	10.30874	4,90
19.5	7.5	1.5	45°	10.13493	4,20	10.30875	4,90
19.5	8.0	1.5	45°	10.13494	4,20	10.13945	4,90
19.5	9.0	1.5	45°	10.13495	3,90	10.13946	4,40
19.5	10.0	1.5	45°	10.13496	4,20	10.30876	4,90
19.5	11.0	1.5	45°	10.13497	4,20	10.30877	4,90
19.5	12.0	1.5	45°	10.13498	3,90	10.13947	4,40
29.5	7.0	1.5	45°	10.13501	4,50	10.30878	5,30
29.5	7.5	1.5	45°	10.13502	4,50	10.13948	5,30
29.5	8.0	1.5	45°	10.13503	4,50	10.13949	5,30
29.5	9.0	1.5	45°	10.13504	4,20	10.13950	4,70
29.5	10.0	1.5	45°	10.13505	4,20	10.30879	5,00
29.5	11.0	1.5	45°	10.13506	4,20	10.30880	5,00
29.5	12.0	1.5	45°	10.13507	4,10	10.13952	4,80
39.5	9.0	1.5	45°	10.13511	4,90	10.45134	5,80
39.5	12.0	1.5	45°	10.13512	4,70	10.13954	5,00
49.5	8.0	1.5	45°	10.13516	5,00	10.13955	6,35
49.5	9.0	1.5	45°	10.13517	4,80	10.13956	4,75
49.5	10.0	1.5	45°	10.13518	5,00	10.30881	6,35
49.5	11.0	1.5	45°	10.13519	5,00	10.30882	6,35
49.5	12.0	1.5	45°	10.13520	5,00	10.13957	5,60
59.5	12.0	1.5	45°	10.13523	5,00	10.13958	6,00
50.0	12.0	1.7	45°	10.13327	5,00	10.13866	4,90
50.0	10.0	1.7	45°	10.16966	5,20	10.30883	7,00
20.0	5.5	1.1	45°			10.49525	5,25
20.0	10.0	1.5	45°			10.14273	5,25
30.0	10.0	1.5	45°			10.14275	5,70
50.0	10.0	1.5	45°			10.14277	6,90
50.0	10.0	1.5	45°			10.14279	10,50
28.0	7.0	1.5	45°	10.16823	6,00	10.16822	6,20
16.0	7.0	1.5	45°	10.16934	4,95	10.16933	4,95

Andere Abmessungen auf Anfrage

Unverbindliche Preisempfehlung · Alle Preise verstehen sich als Verkaufspreise zuzüglich der aktuellen gesetzlichen Mehrwertsteuer · Änderungen vorbehalten

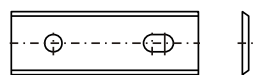
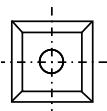
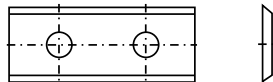
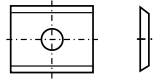
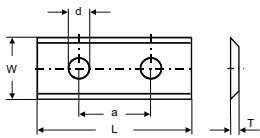

Standard Wendeschneidplatten 45°

L mm	W mm	T mm	a mm	T08MF	€/Stk	T10MG	€/Stk	TL15	€/Stk	TL20	€/Stk
7.5	12.0	1.5	45°			10.14091	2,40	10.13777	2,80	10.50259	2,80
9.6	12.0	1.5	45°			10.14115	3,80	10.12950	4,10	10.50260	4,60
15.0	12.0	1.5	45°			10.14098	3,00	10.13780	3,40	10.43675	3,70
20.0	12.0	1.5	45°			10.14100	3,10	10.13781	3,40	10.43676	3,80
25.0	12.0	1.5	45°			10.14123	4,45	10.13788	4,50	10.50261	5,20
25.0	12.0	1.5	45° 14.0			10.14110	4,45	10.13786	4,50	10.43677	5,20
30.0	12.0	1.5	45° 14.0			10.14102	3,60	10.13783	3,80	10.43678	3,90
40.0	12.0	1.5	45° 26.0			10.14113	3,80	10.13787	4,50	10.43679	4,60
50.0	12.0	1.5	45° 26.0			10.14105	3,70	10.13784	4,30	10.43680	4,40
60.0	12.0	1.5	45° 26.0			10.14107	5,40	10.13785	5,60	10.45506	5,40
12.0	12.0	1.5	45°			10.14096	2,40	10.13778	2,70	10.43674	2,90

>> MICROFINISH <<

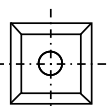
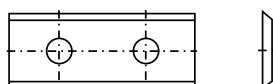
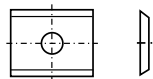

L mm	W mm	T mm	a mm	T08MF	€/Stk	T10MG	€/Stk	TL15	€/Stk	TL20	€/Stk
7.5	12.0	1.5	45°			10.14093	2,80	10.30861	3,80		
9.6	12.0	1.5	45°			10.14117	4,00	10.30864	4,60		
15.0	12.0	1.5	45°			10.14099	3,20	10.30862	3,50		
20.0	12.0	1.5	45°			10.14101	3,20	10.13782	3,90		
25.0	12.0	1.5	45°			10.14124	5,00	10.30865	5,20		
25.0	12.0	1.5	45° 14.0			10.14111	5,00	10.30863	5,20		
30.0	12.0	1.5	45° 14.0			10.14103	3,80	10.30866	4,00		
40.0	12.0	1.5	45° 26.0			10.14114	4,20	10.30870	4,80		
50.0	12.0	1.5	45° 26.0			10.14106	4,20	10.30868	4,80		
60.0	12.0	1.5	45° 26.0			10.14108	5,20	10.30869	5,60		
12.0	12.0	1.5	45°			10.14097	2,95	10.13779	3,10		

Andere Abmessungen auf Anfrage

Unverbindliche Preisempfehlung · Alle Preise verstehen sich als Verkaufspreise zuzüglich der aktuellen gesetzlichen Mehrwertsteuer · Änderungen vorbehalten

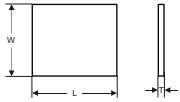

Mini Wendeschneidplatten

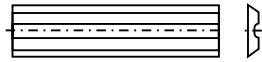

L mm	W mm	T mm	T04F €/Stk	T03SMG €/Stk	
12.0	5.5	1.1	10.13355	1,70	10.13882 1,90
20.0	5.5	1.1	10.13357	2,00	10.13884 2,50
30.0	5.5	1.1	10.13363	2,30	10.13890 2,70
40.0	5.5	1.1	10.13359	2,35	10.13886 2,80
50.0	5.5	1.1	10.13361	2,65	10.13888 2,90

Rückennut

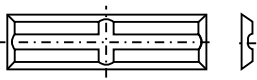

20.0	4.1	1.1	10.13403	3,60	
20.0	5.5	1.1	10.13394	3,25	10.13911 4,10
25.0	5.5	1.1	10.13402	3,55	10.13920 4,40
30.0	5.5	1.1	10.13397	3,55	10.13914 4,50
40.0	5.5	1.1	10.13399	3,70	10.13916 4,60
50.0	5.5	1.1	10.13401	4,00	10.13918 4,90

Rücken- und Quernut

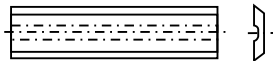

12.0	5.5	1.1	10.13334	1,90	10.13870 1,90
20.0	5.5	1.1	10.13336	2,00	10.13872 2,50
30.0	5.5	1.1	10.13345	2,30	10.13880 2,70
40.0	5.5	1.1	10.13339	2,35	10.13874 2,80
50.0	5.5	1.1	10.13342	2,65	10.13877 2,90

Brustnut

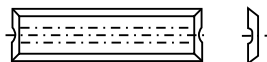

20.0	5.5	1.1	10.13378	3,25	10.30871 4,10
25.0	5.5	1.1	10.13376	3,55	10.30872 4,40
30.0	5.5	1.1	10.13379	3,55	10.30847 4,50
35.0	5.5	1.1	10.13377	3,70	10.13893 4,50
40.0	5.5	1.1	10.13380	3,75	10.13898 4,70
44.5	5.5	1.1	10.13375	4,00	10.30873 4,80
50.0	5.5	1.1	10.13381	4,05	10.13900 4,90

4 Schneidkanten

Wendeplatten mit Spanbrechernuten

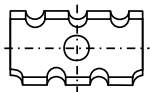

L mm	W mm	T mm	a mm	T04F €/Stk	T03SMG €/Stk	T10MG €/Stk	T08MF €/Stk
20.0	12.0	1.5		10.30928	5,65		
30.0	12.0	1.5	14.0	10.13117	6,10		
50.0	12.0	1.5	26.0	10.13127	6,95		
15.0	15.0	2.0		10.13322	3,55	10.14029	4,70

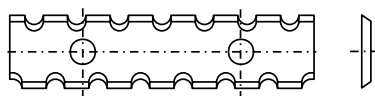

Andere Abmessungen auf Anfrage

Unverbindliche Preisempfehlung · Alle Preise verstehen sich als Verkaufspreise zuzüglich der aktuellen gesetzlichen Mehrwertsteuer · Änderungen vorbehalten

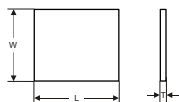

Spezial Wendeschneidplatten 40°

Nur zur Verwendung in
 Messerköpfen der Firma **LEITZ**



L mm	W mm	T mm		T04F €/Stk	T03SMG €/Stk	T10MG €/Stk			
7.7	8.0	1.5	40°	10.13457	2,55	10.13930	3,50	10.14041	3,50
9.7	8.0	1.5	40°	10.13470	2,60	10.13942	3,55	10.14065	3,55
11.7	8.0	1.5	40°	10.13458	3,90	10.13931	3,75	10.14043	3,75
14.7	8.0	1.5	40°	10.13459	3,05	10.13932	3,80	10.14045	3,80
19.7	8.0	1.5	40°	10.13460	3,25	10.13933	3,95	10.14047	3,90
24.7	8.0	1.5	40°	10.13472	3,45	10.13943	4,20	10.14068	4,20
30.0	8.0	1.5	40°	10.13461	3,50	10.13934	4,20	10.14049	4,20
35.0	8.0	1.5	40°	10.13462	3,75	10.13935	4,20	10.14051	4,30
40.0	8.0	1.5	40°	10.13463	3,95	10.13936	4,20	10.14053	4,40
45.0	8.0	1.5	40°	10.13488	4,20	10.49488	4,90	10.14081	4,90
50.0	8.0	1.5	40°	10.13464	4,00	10.13937	4,20	10.14055	4,20
60.0	8.0	1.5	40°	10.13466	4,20	10.13938	4,70	10.14057	4,70
70.0	8.0	1.5	40°	10.13478	9,60	10.30927	12,15	10.14074	9,70
80.0	8.0	1.5	40°	10.13467	9,75	10.13939	12,50	10.14059	12,50
100.0	8.0	1.5	40°	10.13468	12,15	10.13940	15,10	10.14061	15,10
120.0	8.0	1.5	40°	10.13469	20,00	10.49489	20,00	10.14063	22,00

Nur zur Verwendung in
 Messerköpfen der Firma **OERTLI**

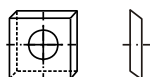
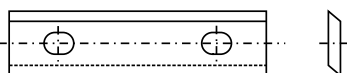
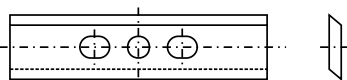
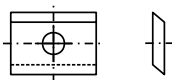

L mm	W mm	T mm		T04F €/Stk	T03SMG €/Stk	T10MG €/Stk	
8.8	8.0	1.5	40°	10.30931	4,20	10.17193	4,80
9.0	8.0	1.5	40°	10.30932	4,20	10.17194	4,80
10.0	8.0	1.5	40°	10.30933	4,20	10.17195	4,80
11.0	8.0	1.5	40°	10.30934	4,20	10.17196	4,80
12.0	8.0	1.5	40°	10.30935	4,20	10.17197	4,80
15.0	8.0	1.5	40°	10.30936	4,20	10.17198	4,80
20.0	8.0	1.5	40°	10.30937	4,60	10.17200	4,95
25.0	8.0	1.5	40°	10.30938	4,80	10.17201	5,20
28.0	8.0	1.5	40°	10.30939	5,30	10.17202	5,50
32.0	8.0	1.5	40°	10.30940	4,20	10.17203	4,80
40.0	8.0	1.5	40°	10.30941	5,20	10.17204	5,60
50.0	8.0	1.5	40°	10.30942	5,00	10.17206	5,60
60.0	8.0	1.5	40°	10.30943	9,50	10.17207	12,75
80.0	8.0	1.5	40°	10.30944	14,75	10.17209	18,50
100.0	8.0	1.5	40°	10.30945	18,00	10.17210	20,50
12.0	8.0	1.5	40°	10.34294	9,50	10.34295	12,75

Andere Abmessungen auf Anfrage

Unverbindliche Preisempfehlung · Alle Preise verstehen sich als Verkaufspreise zuzüglich der aktuellen gesetzlichen Mehrwertsteuer · Änderungen vorbehalten

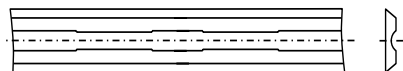
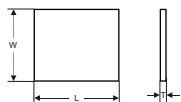

Wendeplatten mit Handhobel

L mm	W mm	T mm	T10MF	€/Stk	
56.0	5.5	1.1	10.13041	2,70	Adler
60.0	5.5	1.1	10.13053	2,70	Wegoma
75.5	5.5	1.1	10.13001	2,10	AEG HTH75 Bosch 0590, P400, 1590, 1591 Festo REP75 Haffner FH222 Kress Jet Star 6701 Mafell HU75 Metabo 6375 Scheer MH75/3, MH80 Skil 98H Holz-Her 2223, 2286, 2320
75.7	5.5	1.2	10.13018	2,10	B&D DN75, DN750, BD750, SR6000K
78.0	5.5	1.1	10.13067	2,20	Virutex
80.5	5.9	1.2	10.13043	3,00	ELU MFF80, MFF40, PF161
80.5	5.5	1.1	10.13010	2,90	ELU MFF80
82.0	5.5	1.1	10.13020	2,90	AEG EH82, EH825, EH822, EH450, EH700, EH82-1, H750, EH700R B&D DN76 Bosch PHO 100/150, PHO 200/300, 4387, PHO 2-82/3-82, Gustav, H00882 ALU HH15, HH40, HH04K, HH40EK Fein HS2151 Felisatti TP282 Haffner FH224 Hitachi FU20, F20A, FP20A, P20V Holz-Her 2321, 2322 Mafell EHU82, MHU82 Makita 1100, 1125B, 1900B, 1923B, 1923H Metabo Gustav 4382, M08382, M00882 Peugot RA400, 82RAC, RA82CS, BRA1-82 Ryobi L1323-A Skil H92, H94, H95, H96, H97 Casals CE82
82.7	5.5	1.2	10.13032	2,20	B&D DN710, DN712, DN730, DN71-02, DN71-03, BD711
92.0	5.5	1.1	10.13057	5,70	AEG 450 Hitachi F30A, FU30 Ryobi L120N, L150N, L1205N, L1323
102.0	5.5	1.1	10.13061	5,85	AEG HB750, EH102, HBE800
75.0	12.0	1.8	10.13245	6,70	B&D
75.5	5.1	1.2	10.13031	3,30	
82.0	5.1	1.2	10.13034	3,35	

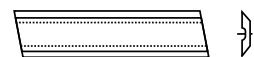
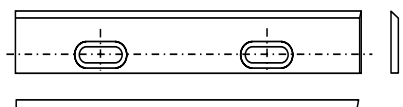

Andere Abmessungen auf Anfrage

Unverbindliche Preisempfehlung · Alle Preise verstehen sich als Verkaufspreise zuzüglich der aktuellen gesetzlichen Mehrwertsteuer · Änderungen vorbehalten

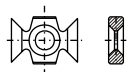

Kantenrunder

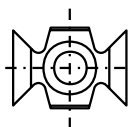
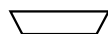

L mm	W mm	T mm	Type	T10MG	€/Stk
16.0	22.0	5.0	TKM 45°	10.32292	12,75
16.0	22.0	5.0	TKM R 1.5	10.32294	12,75
16.0	22.0	5.0	TKM R 2.0	10.32295	12,75
16.0	22.0	5.0	TKM R 2.5	10.32296	12,75
16.0	22.0	5.0	TKM R 3.0	10.32297	12,75
16.0	22.0	5.0	TKM R 4.0	10.32299	12,75
16.0	22.0	6.0	TKM R 5.0	10.32301	12,75
15.0	20.0	8.0	TKM 11/0 – 45°	10.32304	46,00
15.0	17.5	8.0	TKM 11/1 – 60°	10.32305	46,00
15.0	22.3	9.0	TKM 12/0 R3	10.32306	51,00
15.0	20.0	7.3	TKM 12/3 R2	10.32308	46,00
15.0	18.3	7.3	TKM 12/3 R2F	10.32309	46,00
15.0	20.0	7.0	TKM 12/4 R1.5	10.32310	46,00
15.0	22.3	10.0	TKM 12/5 R3F	10.32311	46,00
15.0	22.3	7.3	TKM 13/0 (R1) N = 5	10.32312	46,00
15.0	22.3	9.0	TKM 13/1 (R1) N = 7	10.32313	46,00
15.0	22.3	7.3	TKM 16/0	10.32315	46,00
15.0	23.0	8.0	TKM 21/0 – 45°	10.32316	46,00
15.0	20.5	8.0	TKM 21/1 – 60°	10.32317	46,00
15.0	23.0	9.0	TKM 22/0 R3	10.32318	51,00
15.0	23.0	7.3	TKM 22/3 R2	10.32320	46,00
15.0	23.0	7.0	TKM 22/4 R1.5	10.32322	46,00
15.0	23.0	9.0	TKM 22/5 R3F	10.32323	46,00
15.0	25.7	7.3	TKM 23/0 (R1) N = 5	10.32324	46,00
15.0	25.7	9.3	TKM 23/1 (R1) N = 7	10.32325	51,00
15.0	23.0	9.0	TKM 22/1 R3	10.32319	51,00
15.0	25.7	7.3	TKM 24/0 R5	10.32326	51,00
15.0	25.7	7.3	TKM 24/1 R5	10.32327	51,00
15.0	25.7	7.3	TKM 26/0	10.32329	46,00

Für Leitz-System
 Mechanical

Für Leitz-System
 „BG-Test“

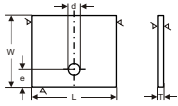

Profilierte Standardblanketts

L mm	W mm	T mm	d mm	e mm	R mm	T04F €/Stk	T03SMG €/Stk	T10MG €/Stk			
13.0	16.0	2.0	3.0		2-4	10.15176	7,00	10.33175	7,10	10.33176	7,00
13.0	16.0	2.0	4.0		2-4	10.15177	7,00	10.33178	7,10	10.33179	7,00
20.0	21.0	2.0	3.0		5-8	10.15180	8,00	10.33181	9,17	10.33182	9,00
20.0	21.0	2.0	4.0		5-8	10.15181	8,00	10.33184	9,17	10.33185	9,00
26.0	24.0	2.0	3.0		9-13	10.15183	10,00	10.33187	11,50	10.33188	11,00
26.0	24.0	2.0	4.0		9-13	10.15185	10,00	10.33190	11,50	10.33191	11,00
12.0	14.5	2.0	4.0	6.0		10.17731	4,82	10.34072	6,05	10.34073	5,90
12.0	18.0	2.0	4.0	6.0		10.19815	4,07	10.34075	5,20	10.34076	5,00
12.0	18.0	2.0	5.0	5.5		10.37116	4,07	10.40950	5,20	10.40952	5,00
19.6	15.5	2.0	4.0	6.0		10.35156	4,90	10.40942	6,20	10.40947	6,00
19.6	15.5	2.0	4.0	6.0		10.35157	4,90	10.40943	6,20	10.40945	6,00
13.0	14.0	1.5	3.2		2-4	10.15189	5,67	10.33193	7,10	10.33194	6,90
20.0	16.0	2.0	3.2		5-8	10.15191	7,35	10.33203	9,17	10.33204	8,90
26.0	18.0	2.0	3.2		9-13	10.15193	9,20	10.33206	10,75	10.33207	11,00
30.0	20.0	2.0	3.2		14-16	10.15195	11,35	10.33213	14,17	10.33214	13,60
16.0	17.5	2.0	3.0	5.0	2-6	10.17550	5,98	10.34059	7,50	10.34060	7,30
16.0	17.5	2.0	3.5	5.0	2-6	10.15235	5,98	10.33227	7,50	10.33228	7,30
16.0	17.5	2.0	4.0	5.0	2-6	10.15242	5,98	10.33233	7,50	10.33234	7,30
20.0	17.5	2.0	4.0	6.0	2-8	10.15239	7,05	10.33236	8,80	10.33237	9,30
20.0	20.5	2.0	4.0	6.3	2-6	10.15245	7,80	10.33239	9,75	10.33240	9,90
20.0	17.5	2.0	3.0	5.0	2-6	10.15248	7,05	10.33242	9,30	10.33243	9,50
16.0	17.5	2.0	4.4	5.4	2-6	10.15243	5,98	10.33230	7,50	10.33231	7,30
24.0	20.4	2.0	4.2	6.3	2-6	10.15247	10,25				
15.0	15.0	2.0	4.0	6.0		10.22306	5,40	10.34081	6,40	10.34082	6,00
16.0	14.6	2.0	5.0	6.0		10.46698	5,25				

Andere Abmessungen auf Anfrage

Unverbindliche Preisempfehlung · Alle Preise verstehen sich als Verkaufspreise zuzüglich der aktuellen gesetzlichen Mehrwertsteuer · Änderungen vorbehalten

Profilierte Standardblanketts

Nur zur Verwendung in Messer-
 köpfen der Firma **LEUCO**

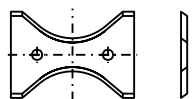
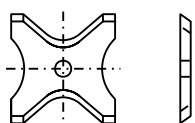
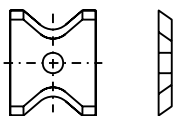

L mm	W mm	T mm	d mm	R mm		T04F €/Stk	T03SMG €/Stk	T10MG €/Stk
13.0	16.0	2.0	4.0	2.0		10.32836 12,30	10.32876 16,00	10.32904 15,00
13.0	16.0	2.0	4.0	3.0		10.32837 12,30	10.32877 16,00	10.32909 15,00
13.0	16.0	2.0	4.0	4.0		10.32838 12,30	10.32878 16,00	10.32908 15,00
20.0	21.0	2.0	4.0	5.0		10.32839 15,50	10.32911 16,00	10.32910 16,00
20.0	21.0	2.0	4.0	6.0		10.32840 15,50	10.32879 16,00	10.32913 16,00
20.0	21.0	2.0	4.0	7.0		10.32841 15,50	10.32880 16,00	10.32914 16,00
20.0	21.0	2.0	4.0	8.0		10.32842 15,50	10.32881 16,00	10.32915 16,00
26.0	24.0	2.0	4.0	9.0		10.32843 16,60	10.32882 19,00	10.32919 19,00
26.0	24.0	2.0	4.0	10.0		10.32844 16,60	10.32883 19,00	10.32920 19,00
26.0	24.0	2.0	4.0	11.0		10.32845 16,60	10.32884 19,00	10.32921 19,00
26.0	24.0	2.0	4.0	12.0		10.32846 16,60	10.32885 19,00	10.32922 19,00
26.0	24.0	2.0	4.0	13.0		10.32847 16,60	10.32886 19,00	10.32923 19,00
30.0	25.0	2.0	4.0	14.0		10.32848 21,35	10.33782 24,50	10.33783 24,00
30.0	25.0	2.0	4.0	15.0		10.32849 21,35	10.33785 24,50	10.33786 24,00
30.0	25.0	2.0	4.0	16.0		10.32850 21,35	10.33788 24,50	10.33789 24,00

Nur zur Verwendung in Messer-
 köpfen der Firma **HOWEMA**

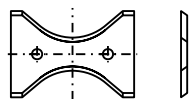
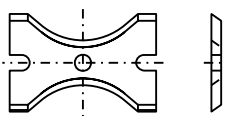
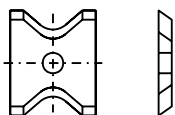

L mm	W mm	T mm	d mm	R mm		T04F €/Stk	T03SMG €/Stk	T10MG €/Stk
13.0	14.0	1.5	3.2	2.0		10.16376 12,20	10.33809 15,15	10.33810 15,00
13.0	14.0	1.5	3.2	3.0		10.16377 12,20	10.33812 15,15	10.33813 15,00
13.0	14.0	1.5	3.2	4.0		10.16378 12,20	10.33815 15,15	10.33816 15,00
20.0	16.0	2.0	3.2	5.0		10.16379 16,00	10.33818 19,00	10.33819 18,00
20.0	16.0	2.0	3.2	6.0		10.16380 16,00	10.33821 19,00	10.33822 18,00
20.0	16.0	2.0	3.2	7.0		10.16381 16,00	10.33824 19,00	10.33825 18,00
20.0	16.0	2.0	3.2	8.0		10.16382 16,00	10.33827 19,00	10.33828 18,00
26.0	18.0	2.0	3.2	9.0		10.16383 18,00	10.33830 21,80	10.33831 21,25
26.0	18.0	2.0	3.2	10.0		10.16384 18,00	10.33833 21,80	10.33834 21,25
26.0	18.0	2.0	3.2	11.0		10.16385 18,00	10.33836 21,80	10.33837 21,25
26.0	18.0	2.0	3.2	12.0		10.16386 18,00	10.33839 21,80	10.33840 21,50
26.0	18.0	2.0	3.2	12.5		10.16391 18,00	10.33867 21,80	10.33868 21,50
30.0	20.0	2.0	3.2	13.0		10.16387 21,50	10.33842 24,50	10.33843 23,50
30.0	20.0	2.0	3.2	14.0		10.16388 21,50	10.33845 24,50	10.33846 23,50
30.0	20.0	2.0	3.2	15.0		10.16389 21,50	10.33848 24,50	10.33849 23,50
30.0	20.0	2.0	3.2	16.0		10.16390 21,50	10.33851 24,50	10.33852 23,50
40.0	28.0	2.0	3.2	17.0		10.16371 26,00	10.33854 29,50	10.33855 28,50
40.0	28.0	2.0	3.2	18.0		10.16372 26,00	10.33857 29,50	10.33858 28,50
40.0	28.0	2.0	3.2	19.0		10.16373 26,00	10.33860 29,50	10.33851 28,50
40.0	28.0	2.0	3.2	20.0		10.16374 26,00	10.33863 29,50	10.33864 28,50

Andere Abmessungen auf Anfrage

Unverbindliche Preisempfehlung · Alle Preise verstehen sich als Verkaufspreise zuzüglich der aktuellen gesetzlichen Mehrwertsteuer · Änderungen vorbehalten

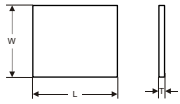

Profilierte Standardblanketts

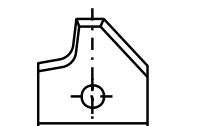
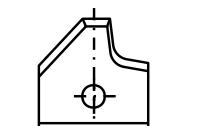
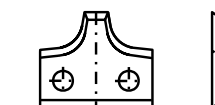
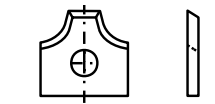
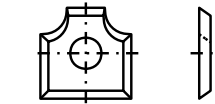

L mm	W mm	T mm	d mm	R mm		T04F €/Stk	T03SMG €/Stk	T10MG €/Stk			
12.0	12.0	1.5	4.0	2.0		10.16426	9,20	10.33022	11,10	10.33024	11,10
12.0	12.0	1.5	4.0	3.0		10.16427	9,20	10.33021	11,10	10.33025	11,10
12.0	12.0	1.5	4.0	4.0		10.16428	9,20	10.33023	11,10	10.33026	11,10
12.0	13.0	2.0	4.0	2.0		10.20990	10,90	10.33877	12,75	10.33878	12,75
12.0	13.0	2.0	4.0	2.5		10.22185	10,90	10.33874	12,75	10.33875	12,75
12.0	13.0	2.0	4.0	3.0		10.20853	10,90	10.33871	12,75	10.33872	12,75
16.0	14.0	2.0	4.0	3.0		10.39045	14,50				
16.0	17.5	2.0	3.0	2.0		10.16515	12,25	10.33880	15,00	10.33881	14,60
16.0	17.5	2.0	3.0	3.0		10.16516	12,25	10.33883	15,00	10.33884	14,60
16.0	17.5	2.0	3.0	4.0		10.16518	12,25	10.33886	15,00	10.33887	14,60
16.0	17.5	2.0	3.0	5.0		10.16519	12,25	10.33889	15,00	10.33890	14,60
16.0	17.5	2.0	3.5	2.0		10.16469	12,25	10.33892	15,00	10.33893	14,60
16.0	17.5	2.0	3.5	3.0		10.16470	12,25	10.33895	15,00	10.33896	14,60
16.0	17.5	2.0	3.5	4.0		10.16472	12,25	10.33898	15,00	10.33899	14,60
16.0	17.5	2.0	3.5	5.0		10.16473	12,25	10.33901	15,00	10.33902	14,60
16.0	17.5	2.0	3.5	6.0		10.16474	12,25	10.33904	15,00	10.33905	14,60
16.0	17.5	2.0	4.0	2.0		10.16477	12,25	10.32968	15,00	10.32973	14,60
16.0	17.5	2.0	4.0	3.0		10.16478	12,25	10.32969	15,00	10.32974	14,60
16.0	17.5	2.0	4.0	4.0		10.16479	12,25	10.32970	15,00	10.32975	14,60
16.0	17.5	2.0	4.0	5.0		10.16480	12,25	10.32971	15,00	10.32976	14,60
16.0	17.5	2.0	4.4	2.0		10.16510	12,25	10.33907	15,00	10.33908	14,60
16.0	17.5	2.0	4.4	3.0		10.16511	12,25	10.33910	15,00	10.33911	14,60
16.0	17.5	2.0	4.4	4.0		10.16512	12,25	10.33913	15,00	10.33914	14,60
16.0	17.5	2.0	4.4	5.0		10.16513	12,25	10.33916	15,00	10.33917	14,60
24.0	20.0	2.0	4.4	6.0		10.33919	15,30	10.33924	17,00	10.33925	16,00
24.0	20.0	2.0	4.4	7.0		10.33920	15,30	10.33927	17,00	10.33928	16,00
24.0	20.0	2.0	4.4	8.0		10.33921	15,30	10.33930	17,00	10.33931	16,00
24.0	20.0	2.0	4.4	9.0		10.33922	15,30	10.33933	17,00	10.33934	16,00
24.0	20.0	2.0	4.4	10.0		10.33923	15,30	10.33936	17,00	10.33937	16,00
20.0	20.5	2.0	4.0	2.0		10.16495	18,75	10.32991	21,00	10.32996	20,50
20.0	20.5	2.0	4.0	3.0		10.16496	18,75	10.32992	21,00	10.32997	20,50
20.0	20.5	2.0	4.0	4.0		10.16497	18,75	10.32993	21,00	10.32998	20,50
20.0	20.5	2.0	4.0	5.0		10.16498	18,75	10.32994	21,00	10.32999	20,50
20.0	20.5	2.0	4.0	6.0		10.16499	18,75	10.32995	21,00	10.33000	20,50
20.0	20.5	2.0	4.0	2.0		10.16500	18,75	10.33007	21,00	10.33011	20,50
20.0	20.5	2.0	4.0	3.0		10.16501	18,75	10.33006	21,00	10.33012	20,50
20.0	20.5	2.0	4.0	4.0		10.16502	18,75	10.33008	21,00	10.33013	20,50
20.0	20.5	2.0	4.0	5.0		10.16503	18,75	10.33009	21,00	10.33014	20,50
20.0	20.5	2.0	4.0	6.0		10.16504	18,75	10.33010	21,00	10.33015	20,50

Andere Abmessungen auf Anfrage

Unverbindliche Preisempfehlung · Alle Preise verstehen sich als Verkaufspreise zuzüglich der aktuellen gesetzlichen Mehrwertsteuer · Änderungen vorbehalten

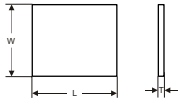

Profilierte Standardblanketts

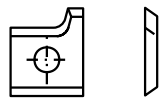
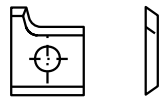
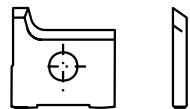
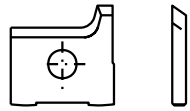

IMA



IMA

Quadromat

MFA

Quadromat

MFA

L mm	W mm	T mm	d mm	R mm		T04F €/Stk	T03SMG €/Stk	T10MG €/Stk			
15.0	14.5	2.0	4.0	2.0		10.22305	13,50	10.33941	15,70	10.33942	15,50
15.0	14.5	2.0	4.0	2.5		10.33939	13,50	10.33947	15,70	10.33948	15,50
15.0	14.5	2.0	4.0	3.0		10.22308	13,50	10.33953	15,70	10.33954	15,50
16.1	14.0	2.0	5.0	2.0		10.46693	14,60				
16.1	14.0	2.0	5.0	3.0		10.49986	14,60				
15.0	14.5	2.0	4.0	2.0		10.22307	13,50	10.33944	15,70	10.33945	15,50
15.0	14.5	2.0	4.0	2.5		10.33940	13,50	10.33950	15,70	10.33951	15,50
15.0	14.5	2.0	4.0	3.0		10.22309	13,50	10.33956	15,70	10.33957	15,50
16.1	14.0	2.0	5.0	2.0		10.46694	14,60				
16.1	14.0	2.0	5.0	3.0		10.49987	14,60				
12.0	14.5	2.0	4.0	2.0		10.21044	12,50	10.33973	14,75	10.33974	14,50
19.6	15.2	2.0	4.0	2.0		10.33963	14,00	10.33997	16,25	10.33998	16,00
12.0	14.5	2.0	4.0	2.5		10.20397	12,50	10.34109	14,75	10.34110	14,50
12.0	14.5	2.0	4.0	3.0		10.20620	12,50	34100	14,75	10.34101	14,50
19.6	15.2	2.0	4.0	3.0		10.33967	14,00	10.34003	16,25	10.34004	16,00
12.0	14.5	2.0	4.0	2.0		10.21045	12,50	10.33981	14,75	10.33982	14,50
19.6	14.5	2.0	4.0	2.0		10.33966	14,00	10.34000	16,25	10.34001	16,00
12.0	14.5	2.0	4.0	2.5		10.20396	12,50	10.34106	14,75	10.34107	14,50
12.0	14.5	2.0	4.0	3.0		10.20619	12,50	10.34103	16,25	10.34104	14,50
19.6	15.2	2.0	4.0	3.0		10.33968	14,00	10.34006	16,25	10.34007	16,00
12.0	18.0	2.0	4.0	2.0		10.33969	18,00	10.34009	22,00	10.34010	21,50
12.0	18.0	2.0	4.0	3.0		10.33970	18,00	10.34015	22,00	10.34017	21,50
12.0	18.0	2.0	4.0	2.0		10.34024	18,00	10.34037	22,00	10.34038	21,50
12.0	18.0	2.0	4.0	3.0		10.34031	18,00	10.34040	22,00	10.34041	21,50
12.0	18.0	2.0	4.0	2.0		10.33971	18,00	10.34015	22,00	10.34013	21,50
12.0	18.0	2.0	4.0	3.0		10.33972	18,00	10.34019	22,00	10.34020	21,50
12.0	18.0	2.0	4.0	2.0		10.34025	18,00	10.41378	22,00	10.41379	21,50
12.0	18.0	2.0	4.0	3.0		10.34032	18,00	10.40440	22,00	10.41381	21,50

Andere Abmessungen auf Anfrage

Unverbindliche Preisempfehlung · Alle Preise verstehen sich als Verkaufspreise zuzüglich der aktuellen gesetzlichen Mehrwertsteuer · Änderungen vorbehalten

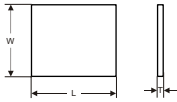

Profilierte Standardblanketts

L mm	W mm	T mm	d mm	a mm	R mm	T04F €/Stk	T03SMG €/Stk	T10MG €/Stk			
20.5	15.0	2.0	4.0	12.0	2.0	10.16429	14,50	10.33565	17,50	10.33566	16,00
20.8	15.0	2.0	4.0	12.0	3.0	10.16430	14,50	10.33568	17,50	10.33569	16,00
20.8	15.0	2.0	4.0	12.0	4.0	10.16431	14,50	10.33571	17,50	10.33572	16,00
30.0	17.0	2.0	4.0	20.0	5.0	10.16432	22,00	10.33574	21,50	10.33575	21,00
30.5	17.0	2.0	4.0	20.0	6.0	10.16433	22,00	10.33577	21,50	10.33578	21,00
30.0	17.0	2.0	4.0	20.0	7.0	10.16434	22,00	10.33580	21,50	10.33581	21,00
30.5	17.0	2.0	4.0	20.0	8.0	10.16435	22,00	10.33583	21,50	10.33584	21,00
30.5	16.5	2.0	4.0	20.0	5.0	10.16452	22,00	10.33595	21,50	10.33596	21,00
30.5	16.5	2.0	4.0	20.0	6.0	10.16453	22,00	10.33598	21,50	10.33599	21,00
30.5	16.5	2.0	4.0	20.0	7.0	10.16454	22,00	10.33601	21,50	10.33602	21,00
30.5	16.5	2.0	4.0	20.0	8.0	10.16455	22,00	10.33604	21,50	10.33605	21,00
20.0	16.0	2.0	3.0		3.0	10.33311	15,50	10.33607	17,002	10.33608	19,00
30.0	14.0	2.0	4.0		2.0	10.33312	17,50	10.33610	19,00	10.33611	20,00
30.0	14.0	2.0	4.0		2.5	10.33313	17,50	10.33613	19,00	10.33614	20,00
30.0	14.0	2.0	4.0		3.0	10.33314	17,50	10.33616	19,00	10.33617	20,00
20.0	16.0	2.0	3.0		3.0	10.33315	15,15	10.33619	17,00	10.33620	19,00
30.0	14.0	2.0	4.0		2.0	10.33316	17,50	10.33622	19,00	10.33623	20,00
30.0	14.0	2.0	4.0		2.5	10.33317	17,50	10.33625	19,00	10.33626	20,00
30.0	14.0	2.0	4.0		3.0	10.33318	17,50	10.33628	19,00	10.33629	20,00
12.0	12.0	1.5	4.0		45°	10.33319	10,50	10.33632	10,75	10.33633	10,00
16.5	17.5	1.0	4.0		45°	10.32964	13,25	10.33965	15,00	10.32966	14,00
16.5	17.5	2.0	4.4		45°	10.33324	13,25	10.41057	15,00	10.41058	14,00
16.5	17.5	2.0	3.5		45°	10.15237	13,25	10.34112	15,00	10.34113	14,00
21.8	19.5	2.0	3.0	12.0	10.0	10.33670	21,00	10.33674	20,00	10.33675	19,00
21.8	19.5	2.0	3.0	12.0	12.0	10.33671	21,00	10.33677	20,00	10.33678	19,00
21.5	20.0	2.0	3.0	12.0	9.0	10.16445	21,00	10.33657	20,00	10.33658	19,00
21.5	20.0	2.0	3.0	12.0	10.0	10.16446	21,00	10.33660	20,00	10.33661	19,00
21.5	20.0	2.0	3.0	12.0	11.0	10.16447	21,00	10.33663	20,00	10.33664	19,00
21.5	20.0	2.0	3.0	12.0	12.0	10.16448	21,00	10.33666	20,00	10.33667	19,00
21.8	19.5	2.0	3.0	12.0	10.0	10.33672	21,00	10.33680	20,00	10.33681	19,00
21.8	19.5	2.0	3.0	12.0	12.0	10.33673	21,00	10.33685	20,00	10.33686	19,00
21.5	20.0	2.0	3.0	12.0	9.0	10.16436	21,00	10.33645	20,00	10.33646	19,00
21.5	20.0	2.0	3.0	12.0	10.0	10.16437	21,00	10.33648	20,00	10.33649	19,00
21.5	20.0	2.0	3.0	12.0	11.0	10.16438	21,00	10.33651	20,00	10.33652	19,00
21.5	20.0	2.0	3.0	12.0	12.0	10.16439	21,00	10.33654	20,00	10.33655	19,00

Andere Abmessungen auf Anfrage

Unverbindliche Preisempfehlung · Alle Preise verstehen sich als Verkaufspreise zuzüglich der aktuellen gesetzlichen Mehrwertsteuer · Änderungen vorbehalten

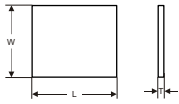

Profilierte Standardblanketts

L mm	W mm	T mm	d mm	R mm	A°	T04F €/Stk	T03SMG €/Stk	T06MF €/Stk
20.0	12.0	2.0	4.0	1.0	6°	10.32984 22,00	10.33031 26,00	
20.0	12.0	2.0	4.0	1.0	15°	10.50309 22,00	10.50310 26,00	
20.0	12.0	2.0	4.0	2.0	6°	10.16419 22,00	10.33033 26,00	
20.0	12.0	2.0	4.0	2.0	15°	10.50311 22,00	10.50312 26,00	
20.0	12.0	2.0	4.0	3.0	6°	10.16420 22,00	10.33034 26,00	
20.0	12.0	2.0	4.0	3.0	15°	10.50313 22,00	10.50314 26,00	
20.0	12.0	2.0	4.0	4.0	6°	10.16421 22,00	10.33043 26,00	
20.0	12.0	2.0	4.0	5.0	6°	10.16422 22,00	10.33042 26,00	
20.0	11.5	2.0		1.5		10.50088 19,50		
20.0	11.5	2.0		2.0		10.50089 19,50		
20.0	11.5	2.0		2.5		10.50090 19,50		
20.0	11.5	2.0		3.0		10.50091 19,50		
12.7	12.7	3.2		2.0				10.35041 21,00
12.7	12.7	3.2		3.0				10.37922 21,00
15.5	15.2	1.5	4.6	3.0	35°	10.21377 25,87		
19.5	9.0	1.5	4.0	5x45°		10.33086 13,20	10.33118 14,00	
19.5	12.0	1.5		5x45°		10.34228 13,20	10.34229 14,00	
19.5	9.0	1.5	4.0	5.0		10.33090 13,20	10.33128 14,00	
19.5	12.0	1.5	4.0	5.0		10.34232 13,20	10.34233 14,00	
19.5	9.0	1.5	4.0	2.0		10.33117 13,20	10.33142 14,00	
19.5	9.0	1.5	4.0	3.0		10.33097 13,20	10.33146 14,00	
19.5	9.0	1.5	4.0	4.0		10.33098 13,20	10.33149 14,00	
19.5	9.0	1.5	4.0	5.0		10.33099 13,20	10.33152 14,00	
19.5	12.0	1.5	4.0	2.0		10.34236 13,20	10.34240 14,00	
19.5	12.0	1.5	4.0	3.0		10.34237 13,20	10.34243 14,00	
19.5	12.0	1.5	4.0	4.0		10.34238 13,20	10.34246 14,00	
19.5	12.0	1.5	4.0	5.0		10.34239 13,20	10.34249 14,00	
39.5	12.0	1.5	4.0			10.33400 16,50	10.33401 17,50	

Andere Abmessungen auf Anfrage

Unverbindliche Preisempfehlung · Alle Preise verstehen sich als Verkaufspreise zuzüglich der aktuellen gesetzlichen Mehrwertsteuer · Änderungen vorbehalten

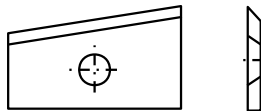
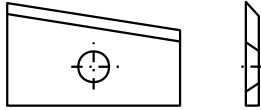
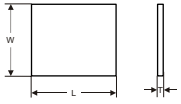

Profilierte Standardblanketts

L mm	W mm	T mm	d mm	a mm			T04F	€/Stk
50.0	21.6	2.0	4.1	26.0			10.35810	40,80
30.0	22.5	3.0					10.20272	26,00
55.0	25.0	3.0					10.20502	43,00
30.0	22.5	3.0					10.20273	26,00
55.0	25.0	3.0					10.20503	43,00

Profilierte Standardblanketts

Nur zur Verwendung in Messer-
 köpfen der Firma **OERTLI**



L mm	W mm	T mm	Type	T04F	€/Stk	T10MG	€/Stk
20.0	13.5	2.0	TW32-R2	10.33429	22,00	10.33430	25,00
20.0	13.5	2.0	TW32-R3	10.33427	22,00	10.33428	25,00
20.0	13.5	2.0	TW32-R4	10.33431	22,00	10.33432	25,00
20.0	13.5	2.0	TW32-R5	10.33433	22,00	10.33434	25,00
20.0	13.5	2.0	TW32-R6	10.33435	22,00	10.33436	25,00
29.0	16.5	2.5	TW32-R7	10.33437	25,00	10.33438	28,00
29.0	16.5	2.5	TW32-R8	10.33439	25,00	10.33440	28,00
29.0	16.5	2.5	TW32-R9	10.33441	25,00	10.33442	28,00
29.0	16.5	2.5	TW32-R10	10.33443	25,00	10.33444	28,00
40.0	21.0	2.5	TW32-R11	10.33445	29,00	10.33446	32,00
40.0	21.0	2.5	TW32-R11.5	10.33447	36,00	10.33448	40,00
40.0	21.0	2.5	TW32-R12	10.33449	29,00	10.33450	32,00
40.0	21.0	2.5	TW32-R13	10.33451	29,00	10.33452	32,00
40.0	21.0	2.5	TW32-R14	10.33453	29,00	10.33454	32,00

Wendeplatten für Spiralhobelköpfe

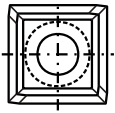
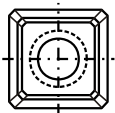
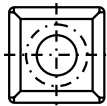
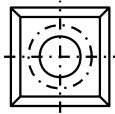
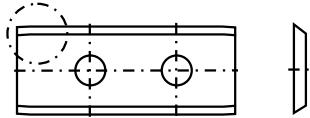
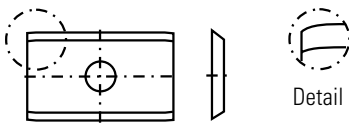

L mm	W mm	T mm		T08MF €/Stk	T04F €/Stk	T10MG €/Stk	TL15 €/Stk		
20.0	12.0	1.5	35°			10.13979	4,00		
24.5	12.0	1.5	40°	10.37246	4,10	10.41060	4,20		
30.5	12.0	1.5	35°			10.13984	4,30		
50.0	12.0	1.5	35°			10.13989	5,75		
10.5	10.5	1.5	35°				10.40343	2,55	
14.0	14.0	2.0	30°	10.13273	1,30	10.13260	1,50	10.14028	1,80
14.0	14.0	2.0	30°	10.13276	3,76				
15.0	15.0	2.5	R=150			10.13320	4,20		
15.0	15.0	2.5	R=50			10.43895	4,20		
14.0	14.0	2.0	30°	10.44486	2,75				
15.0	15.0	2.5	30°			10.44289	4,10		

Hobelmesser – System Bulldozer

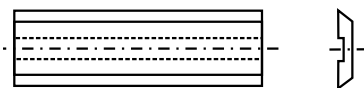
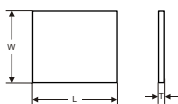

L mm	W mm	T mm	T10MG €/Stück
60.0	13.6	1.8	10.47422
80.0	13.6	1.8	10.46288
100.0	13.6	1.8	10.13713
110.0	13.6	1.8	10.47423
120.0	13.6	1.8	10.13715
130.0	13.6	1.8	10.13716
140.0	13.6	1.8	10.13723
150.0	13.6	1.8	10.13718
160.0	13.6	1.8	10.13726
180.0	13.6	1.8	10.13719
190.0	13.6	1.8	10.13725
200.0	13.6	1.8	10.13720
230.0	13.6	1.8	10.13721
240.0	13.6	1.8	10.40337
250.0	13.6	1.8	10.13722
260.0	13.6	1.8	10.35440

Andere Abmessungen auf Anfrage

Unverbindliche Preisempfehlung · Alle Preise verstehen sich als Verkaufspreise zuzüglich der aktuellen gesetzlichen Mehrwertsteuer · Änderungen vorbehalten

Rundstäbe

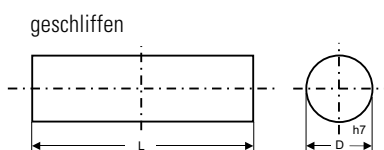

D mm	L mm	Tolerance mm	T10MG	€/Stück
3.0	320.0	h7	10.29708	15,25
3.5	320.0		10.35521	17,90
4.0	320.0		10.29710	18,60
4.5	320.0		10.35522	23,45
5.0	320.0		10.34802	24,25
5.5	320.0		10.35523	29,85
6.0	320.0		10.29712	31,60
6.5	320.0		10.35524	36,60
7.0	320.0		10.35525	37,85
8.0	320.0		10.29714	47,70
9.0	320.0		10.35528	56,00
9.5	320.0		10.35529	64,30
10.0	320.0		10.29716	64,95
11.0	320.0		10.35531	76,90
12.0	320.0		10.29718	89,00
13.0	320.0		10.35534	100,68
14.0	320.0		10.29720	118,75
16.0	320.0		10.29722	145,15
18.0	320.0		10.29724	176,65
20.0	320.0		10.29726	218,95
25.0	320.0	10.29728	336,75	

D Inch	L Inch	Tolerance mm	T10MG	€/Stück
1/8	12 1/4	h7	10.50139	16,40
5/32	12 1/4		10.50140	17,95
3/16	12 1/4		10.50147	21,70
7/32	12 1/4		10.50148	29,95
15/64	12 1/4		10.50149	31,70
1/4	12 1/4		10.50150	32,80
5/16	12 1/4		10.50151	46,15
3/8	12 1/4		10.50152	60,30
7/16	12 1/4		10.50153	79,15
1/2	12 1/4		10.50154	96,50
9/16	12 1/4		10.50155	127,30
5/8	12 1/4		10.50156	142,90
3/4	12 1/4		10.50157	192,00
1	12 1/4		10.50158	338,75

Rundstäbe

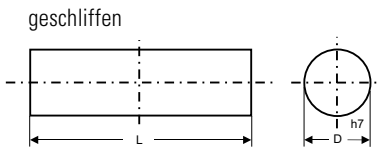

D mm	L mm	Tolerance mm	T10MG	€/Stück
4.0	50.0	h7	10.34178	2,90
4.0	55.0		10.39104	3,20
4.0	60.0		10.41480	3,50
4.5	55.0		10.39105	4,00
5.0	50.0		10.34179	3,80
5.0	55.0		10.39106	4,20
6.0	55.0		10.39107	4,45
6.0	60.0		10.34180	5,95
8.0	70.0		10.38349	10,45
8.0	75.0		10.41481	11,20
8.0	80.0		10.34181	11,95
10.0	70.0		10.38350	14,20
10.0	75.0		10.38351	15,25
10.0	100.0		10.34183	20,30
12.0	70.0		10.38732	19,45
12.0	80.0		10.34184	22,25
12.0	90.0		10.38352	25,00
12.0	100.0		10.34185	27,80
14.0	90.0		10.41482	33,40
14.0	100.0		10.34186	37,10
14.0	110.0		10.38353	40,80
16.0	90.0		10.38354	40,85
16.0	100.0		10.34187	45,35
16.0	110.0		10.38355	49,90
16.0	120.0		10.34188	54,45
16.0	140.0		10.38356	63,50
18.0	100.0		10.34189	55,20
18.0	115.0		10.38357	63,50
18.0	120.0		10.34190	66,25
20.0	100.0		10.34192	68,45
20.0	115.0		10.38358	78,70
20.0	120.0		10.34193	82,10
20.0	135.0		10.39115	92,35
20.0	140.0		10.38359	95,80

Wendehobelmesser · System TERSA

für Original TERSA-Grundkörper · HW-Qualität

Bestell-Nr.	Maße in mm	€/Stück	Bestell-Nr.	Maße in mm	€/Stück	Bestell-Nr.	Maße in mm	€/Stück
14.060023	60 x 10 x 2,3	28,25	14.480023	480 x 10 x 2,3	154,50	14.910023	910 x 10 x 2,3	289,50
14.070023	70 x 10 x 2,3	33,00	14.490023	490 x 10 x 2,3	158,50	14.920023	920 x 10 x 2,3	296,00
14.080023	80 x 10 x 2,3	37,75	14.500023	500 x 10 x 2,3	162,00	14.930023	930 x 10 x 2,3	299,00
14.090023	90 x 10 x 2,3	41,50	14.510023	510 x 10 x 2,3	164,00	14.940023	940 x 10 x 2,3	305,50
14.100023	100 x 10 x 2,3	45,25	14.520023	520 x 10 x 2,3	168,50	14.950023	950 x 10 x 2,3	308,00
14.110023	110 x 10 x 2,3	50,50	14.530023	530 x 10 x 2,3	170,50	14.960023	960 x 10 x 2,3	312,00
14.120023	120 x 10 x 2,3	52,50	14.540023	540 x 10 x 2,3	172,50	14.970023	970 x 10 x 2,3	314,50
14.130023	130 x 10 x 2,3	54,00	14.550023	550 x 10 x 2,3	176,50	14.980023	980 x 10 x 2,3	320,00
14.140023	140 x 10 x 2,3	55,50	14.560023	560 x 10 x 2,3	179,50	14.990023	990 x 10 x 2,3	322,50
14.150023	150 x 10 x 2,3	56,50	14.570023	570 x 10 x 2,3	183,50	14.100123	1000 x 10 x 2,3	324,00
14.160023	160 x 10 x 2,3	58,00	14.580023	580 x 10 x 2,3	185,50	14.101123	1010 x 10 x 2,3	329,00
14.170023	170 x 10 x 2,3	61,00	14.590023	590 x 10 x 2,3	189,50	14.102123	1020 x 10 x 2,3	330,50
14.180023	180 x 10 x 2,3	62,00	14.600023	600 x 10 x 2,3	192,50	14.103123	1030 x 10 x 2,3	333,00
14.185023	185 x 10 x 2,3	63,00	14.610023	610 x 10 x 2,3	197,00	14.104123	1040 x 10 x 2,3	334,50
14.190023	190 x 10 x 2,3	63,50	14.620023	620 x 10 x 2,3	200,00	14.105123	1050 x 10 x 2,3	339,50
14.200023	200 x 10 x 2,3	64,50	14.630023	630 x 10 x 2,3	204,50	14.106123	1060 x 10 x 2,3	343,50
14.210023	210 x 10 x 2,3	68,50	14.635023	635 x 10 x 2,3	207,50	14.107123	1070 x 10 x 2,3	345,00
14.220023	220 x 10 x 2,3	70,50	14.637023	637 x 10 x 2,3	207,50	14.108123	1080 x 10 x 2,3	347,50
14.230023	230 x 10 x 2,3	74,50	14.640023	640 x 10 x 2,3	207,50	14.109123	1090 x 10 x 2,3	350,00
14.240023	240 x 10 x 2,3	76,00	14.650023	650 x 10 x 2,3	212,00	14.110123	1100 x 10 x 2,3	353,00
14.250023	250 x 10 x 2,3	81,00	14.660023	660 x 10 x 2,3	215,00	14.111123	1110 x 10 x 2,3	357,00
14.260023	260 x 10 x 2,3	83,00	14.670023	670 x 10 x 2,3	217,50	14.112123	1120 x 10 x 2,3	360,50
14.265023	265 x 10 x 2,3	85,50	14.680023	680 x 10 x 2,3	220,50	14.113123	1130 x 10 x 2,3	362,00
14.270023	270 x 10 x 2,3	88,50	14.690023	690 x 10 x 2,3	223,50	14.114123	1140 x 10 x 2,3	367,50
14.280023	280 x 10 x 2,3	90,50	14.700023	700 x 10 x 2,3	226,00	14.115123	1150 x 10 x 2,3	370,00
14.290023	290 x 10 x 2,3	92,50	14.710023	710 x 10 x 2,3	229,00	14.116123	1160 x 10 x 2,3	371,50
14.300023	300 x 10 x 2,3	97,00	14.720023	720 x 10 x 2,3	231,50	14.117123	1170 x 10 x 2,3	378,50
14.310023	310 x 10 x 2,3	100,50	14.730023	730 x 10 x 2,3	235,00	14.118123	1180 x 10 x 2,3	379,00
14.315023	315 x 10 x 2,3	104,50	14.740023	740 x 10 x 2,3	239,50	14.119123	1190 x 10 x 2,3	383,00
14.320023	320 x 10 x 2,3	104,50	14.750023	750 x 10 x 2,3	242,00	14.120123	1200 x 10 x 2,3	386,00
14.330023	330 x 10 x 2,3	107,50	14.760023	760 x 10 x 2,3	244,00	14.121123	1210 x 10 x 2,3	389,50
14.340023	340 x 10 x 2,3	110,00	14.770023	770 x 10 x 2,3	247,50	14.122123	1220 x 10 x 2,3	395,00
14.350023	350 x 10 x 2,3	113,50	14.780023	780 x 10 x 2,3	250,50	14.123123	1230 x 10 x 2,3	397,50
14.360023	360 x 10 x 2,3	115,50	14.790023	790 x 10 x 2,3	253,50	14.124123	1240 x 10 x 2,3	401,50
14.370023	370 x 10 x 2,3	119,50	14.800023	800 x 10 x 2,3	257,00	14.125123	1250 x 10 x 2,3	404,50
14.380023	380 x 10 x 2,3	122,50	14.810023	810 x 10 x 2,3	260,00	14.126123	1260 x 10 x 2,3	407,00
14.390023	390 x 10 x 2,3	125,00	14.820023	820 x 10 x 2,3	263,00	14.127123	1270 x 10 x 2,3	412,00
14.400023	400 x 10 x 2,3	128,50	14.830023	830 x 10 x 2,3	265,00	14.128123	1280 x 10 x 2,3	414,50
14.410023	410 x 10 x 2,3	132,50	14.840023	840 x 10 x 2,3	270,00	14.129123	1290 x 10 x 2,3	418,50
14.420023	420 x 10 x 2,3	136,00	14.850023	850 x 10 x 2,3	272,50	14.130123	1300 x 10 x 2,3	417,50
14.430023	430 x 10 x 2,3	138,00	14.860023	860 x 10 x 2,3	278,50	14.131123	1310 x 10 x 2,3	425,50
14.440023	440 x 10 x 2,3	141,50	14.870023	870 x 10 x 2,3	279,00	14.132123	1320 x 10 x 2,3	430,50
14.450023	450 x 10 x 2,3	145,50	14.880023	880 x 10 x 2,3	283,00	14.133123	1330 x 10 x 2,3	433,00
14.460023	460 x 10 x 2,3	149,00	14.890023	890 x 10 x 2,3	285,50	14.134123	1340 x 10 x 2,3	436,00
14.470023	470 x 10 x 2,3	161,00	14.900023	900 x 10 x 2,3	289,50	14.135123	1350 x 10 x 2,3	437,00

Andere Abmessungen auf Anfrage

Unverbindliche Preisempfehlung · Alle Preise verstehen sich als Verkaufspreise zuzüglich der aktuellen gesetzlichen Mehrwertsteuer · Änderungen vorbehalten

Wendehobelmesser · System TERSA

für Original TERSA-Grundkörper · HS-Qualität

Bestell-Nr.	Maße in mm	€/Stück	Bestell-Nr.	Maße in mm	€/Stück	Bestell-Nr.	Maße in mm	€/Stück
15.060023	60 x 10 x 2,3	10,10	15.480023	480 x 10 x 2,3	26,59	15.910023	910 x 10 x 2,3	48,83
15.070023	70 x 10 x 2,3	10,35	15.490023	490 x 10 x 2,3	27,10	15.920023	920 x 10 x 2,3	49,08
15.080023	80 x 10 x 2,3	10,74	15.500023	500 x 10 x 2,3	27,61	15.930023	930 x 10 x 2,3	49,34
15.090023	90 x 10 x 2,3	10,99	15.510023	510 x 10 x 2,3	28,12	15.940023	940 x 10 x 2,3	50,11
15.100023	100 x 10 x 2,3	11,38	15.520023	520 x 10 x 2,3	28,38	15.950023	950 x 10 x 2,3	50,62
15.110023	110 x 10 x 2,3	11,50	15.530023	530 x 10 x 2,3	28,63	15.960023	960 x 10 x 2,3	50,87
15.120023	120 x 10 x 2,3	11,76	15.540023	540 x 10 x 2,3	29,14	15.970023	970 x 10 x 2,3	51,13
15.130023	130 x 10 x 2,3	12,14	15.550023	550 x 10 x 2,3	29,65	15.980023	980 x 10 x 2,3	51,38
15.140023	140 x 10 x 2,3	12,27	15.560023	560 x 10 x 2,3	30,17	15.990023	990 x 10 x 2,3	52,15
15.150023	150 x 10 x 2,3	12,40	15.570023	570 x 10 x 2,3	30,42	15.100123	1000 x 10 x 2,3	52,66
15.160023	160 x 10 x 2,3	12,65	15.580023	580 x 10 x 2,3	30,93	15.101123	1010 x 10 x 2,3	52,92
15.170023	170 x 10 x 2,3	13,04	15.590023	590 x 10 x 2,3	31,19	15.102123	1020 x 10 x 2,3	53,43
15.180023	180 x 10 x 2,3	13,42	15.600023	600 x 10 x 2,3	31,70	15.103123	1030 x 10 x 2,3	53,94
15.185023	185 x 10 x 2,3	13,68	15.610023	610 x 10 x 2,3	32,21	15.104123	1040 x 10 x 2,3	54,20
15.190023	190 x 10 x 2,3	13,68	15.620023	620 x 10 x 2,3	32,72	15.105123	1050 x 10 x 2,3	54,71
15.200023	200 x 10 x 2,3	14,06	15.630023	630 x 10 x 2,3	33,49	15.106123	1060 x 10 x 2,3	55,48
15.210023	210 x 10 x 2,3	14,32	15.635023	635 x 10 x 2,3	34,26	15.107123	1070 x 10 x 2,3	55,99
15.220023	220 x 10 x 2,3	14,57	15.637023	637 x 10 x 2,3	34,26	15.108123	1080 x 10 x 2,3	56,75
15.230023	230 x 10 x 2,3	14,83	15.640023	640 x 10 x 2,3	34,26	15.109123	1090 x 10 x 2,3	57,01
15.240023	240 x 10 x 2,3	15,21	15.650023	650 x 10 x 2,3	34,51	15.110123	1100 x 10 x 2,3	57,52
15.250023	250 x 10 x 2,3	15,47	15.660023	660 x 10 x 2,3	35,02	15.111123	1110 x 10 x 2,3	57,78
15.260023	260 x 10 x 2,3	16,11	15.670023	670 x 10 x 2,3	35,28	15.112123	1120 x 10 x 2,3	58,54
15.265023	265 x 10 x 2,3	16,36	15.680023	680 x 10 x 2,3	35,79	15.113123	1130 x 10 x 2,3	59,05
15.270023	270 x 10 x 2,3	16,36	15.690023	690 x 10 x 2,3	36,05	15.114123	1140 x 10 x 2,3	59,57
15.280023	280 x 10 x 2,3	16,87	15.700023	700 x 10 x 2,3	36,81	15.115123	1150 x 10 x 2,3	60,08
15.290023	290 x 10 x 2,3	17,28	15.710023	710 x 10 x 2,3	37,32	15.116123	1160 x 10 x 2,3	60,59
15.300023	300 x 10 x 2,3	17,64	15.720023	720 x 10 x 2,3	37,84	15.117123	1170 x 10 x 2,3	60,84
15.310023	310 x 10 x 2,3	18,02	15.730023	730 x 10 x 2,3	38,35	15.118123	1180 x 10 x 2,3	61,61
15.315023	315 x 10 x 2,3	18,41	15.740023	740 x 10 x 2,3	38,86	15.119123	1190 x 10 x 2,3	61,87
15.320023	320 x 10 x 2,3	18,41	15.750023	750 x 10 x 2,3	39,37	15.120123	1200 x 10 x 2,3	62,83
15.330023	330 x 10 x 2,3	18,79	15.760023	760 x 10 x 2,3	40,39	15.121123	1210 x 10 x 2,3	62,89
15.340023	340 x 10 x 2,3	19,05	15.770023	770 x 10 x 2,3	41,16	15.122123	1220 x 10 x 2,3	63,66
15.350023	350 x 10 x 2,3	19,43	15.780023	780 x 10 x 2,3	41,67	15.123123	1230 x 10 x 2,3	64,17
15.360023	360 x 10 x 2,3	19,94	15.790023	790 x 10 x 2,3	42,44	15.124123	1240 x 10 x 2,3	64,42
15.370023	370 x 10 x 2,3	20,45	15.800023	800 x 10 x 2,3	42,95	15.125123	1250 x 10 x 2,3	65,19
15.380023	380 x 10 x 2,3	20,96	15.810023	810 x 10 x 2,3	43,72	15.126123	1260 x 10 x 2,3	65,45
15.390023	390 x 10 x 2,3	21,47	15.820023	820 x 10 x 2,3	44,23	15.127123	1270 x 10 x 2,3	65,96
15.400023	400 x 10 x 2,3	21,99	15.830023	830 x 10 x 2,3	44,74	15.128123	1280 x 10 x 2,3	66,21
15.410023	410 x 10 x 2,3	22,37	15.840023	840 x 10 x 2,3	45,25	15.129123	1290 x 10 x 2,3	66,72
15.420023	420 x 10 x 2,3	22,75	15.850023	850 x 10 x 2,3	45,76	15.130123	1300 x 10 x 2,3	66,98
15.430023	430 x 10 x 2,3	23,39	15.860023	860 x 10 x 2,3	46,53	15.131123	1310 x 10 x 2,3	67,49
15.440023	440 x 10 x 2,3	24,16	15.870023	870 x 10 x 2,3	47,04	15.132123	1320 x 10 x 2,3	67,75
15.450023	450 x 10 x 2,3	24,87	15.880023	880 x 10 x 2,3	47,81	15.133123	1330 x 10 x 2,3	68,51
15.460023	460 x 10 x 2,3	25,44	15.890023	890 x 10 x 2,3	48,32	15.134123	1340 x 10 x 2,3	69,02
15.470023	470 x 10 x 2,3	25,82	15.900023	900 x 10 x 2,3	48,57	15.135123	1350 x 10 x 2,3	70,05

Andere Abmessungen auf Anfrage

Unverbindliche Preisempfehlung · Alle Preise verstehen sich als Verkaufspreise zuzüglich der aktuellen gesetzlichen Mehrwertsteuer · Änderungen vorbehalten

Wendehobelmesser · System TERSA

für Original TERSA-Grundkörper · **Standard**-Qualität

Bestell-Nr.	Maße in mm	€/Stück	Bestell-Nr.	Maße in mm	€/Stück	Bestell-Nr.	Maße in mm	€/Stück
16.060023	60 x 10 x 2,3	5,62	16.480023	480 x 10 x 2,3	14,06	16.910023	910 x 10 x 2,3	27,61
16.070023	70 x 10 x 2,3	5,75	16.490023	490 x 10 x 2,3	14,32	16.920023	920 x 10 x 2,3	27,87
16.080023	80 x 10 x 2,3	6,01	16.500023	500 x 10 x 2,3	14,57	16.930023	930 x 10 x 2,3	28,12
16.070023	90 x 10 x 2,3	6,14	16.510023	510 x 10 x 2,3	14,83	16.940023	940 x 10 x 2,3	28,12
16.100023	100 x 10 x 2,3	6,14	16.520023	520 x 10 x 2,3	15,21	16.950023	950 x 10 x 2,3	28,38
16.110023	110 x 10 x 2,3	6,26	16.530023	530 x 10 x 2,3	15,47	16.960023	960 x 10 x 2,3	28,38
16.120023	120 x 10 x 2,3	6,39	16.540023	540 x 10 x 2,3	15,72	16.970023	970 x 10 x 2,3	28,63
16.130023	130 x 10 x 2,3	6,39	16.550023	550 x 10 x 2,3	16,11	16.980023	980 x 10 x 2,3	28,63
16.140023	140 x 10 x 2,3	6,52	16.560023	560 x 10 x 2,3	16,36	16.990023	990 x 10 x 2,3	28,63
16.150023	150 x 10 x 2,3	6,65	16.570023	570 x 10 x 2,3	16,87	16.100123	1000 x 10 x 2,3	29,14
16.160023	160 x 10 x 2,3	6,90	16.580023	580 x 10 x 2,3	17,28	16.101123	1010 x 10 x 2,3	29,40
16.170023	170 x 10 x 2,3	7,16	16.590023	590 x 10 x 2,3	17,51	16.102123	1020 x 10 x 2,3	29,65
16.180023	180 x 10 x 2,3	7,29	16.600023	600 x 10 x 2,3	17,77	16.103123	1030 x 10 x 2,3	30,17
16.185023	185 x 10 x 2,3	7,29	16.610023	610 x 10 x 2,3	18,02	16.104123	1040 x 10 x 2,3	30,42
16.190023	190 x 10 x 2,3	7,29	16.620023	620 x 10 x 2,3	18,41	16.105123	1050 x 10 x 2,3	30,68
16.200023	200 x 10 x 2,3	7,41	16.630023	630 x 10 x 2,3	18,79	16.106123	1060 x 10 x 2,3	30,93
16.210023	210 x 10 x 2,3	7,54	16.635023	635 x 10 x 2,3	19,05	16.107123	1070 x 10 x 2,3	31,19
16.220023	220 x 10 x 2,3	7,93	16.637023	637 x 10 x 2,3	19,05	16.108123	1080 x 10 x 2,3	31,44
16.230023	230 x 10 x 2,3	8,44	16.640023	640 x 10 x 2,3	19,05	16.109123	1090 x 10 x 2,3	31,70
16.240023	240 x 10 x 2,3	8,69	16.650023	650 x 10 x 2,3	19,30	16.110123	1100 x 10 x 2,3	32,21
16.250023	250 x 10 x 2,3	8,95	16.660023	660 x 10 x 2,3	19,56	16.111123	1110 x 10 x 2,3	32,47
16.260023	260 x 10 x 2,3	9,08	16.670023	670 x 10 x 2,3	19,94	16.112123	1120 x 10 x 2,3	32,72
16.265023	265 x 10 x 2,3	9,33	16.680023	680 x 10 x 2,3	20,32	16.113123	1130 x 10 x 2,3	33,49
16.270023	270 x 10 x 2,3	9,33	16.690023	690 x 10 x 2,3	20,71	16.114123	1140 x 10 x 2,3	33,75
16.280023	280 x 10 x 2,3	9,59	16.700023	700 x 10 x 2,3	20,90	16.115123	1150 x 10 x 2,3	34,26
16.290023	290 x 10 x 2,3	9,71	16.710023	710 x 10 x 2,3	21,35	16.116123	1160 x 10 x 2,3	34,51
16.300023	300 x 10 x 2,3	9,84	16.720023	720 x 10 x 2,3	21,73	16.117123	1170 x 10 x 2,3	34,77
16.310023	310 x 10 x 2,3	9,97	16.730023	730 x 10 x 2,3	21,99	16.118123	1180 x 10 x 2,3	35,02
16.315023	315 x 10 x 2,3	9,97	16.740023	740 x 10 x 2,3	22,24	16.119123	1190 x 10 x 2,3	35,28
16.320023	320 x 10 x 2,3	10,10	16.750023	750 x 10 x 2,3	22,50	16.120123	1200 x 10 x 2,3	35,53
16.330023	330 x 10 x 2,3	10,23	16.760023	760 x 10 x 2,3	22,75	16.121123	1210 x 10 x 2,3	35,79
16.340023	340 x 10 x 2,3	10,35	16.770023	770 x 10 x 2,3	23,14	16.122123	1220 x 10 x 2,3	36,05
16.350023	350 x 10 x 2,3	10,48	16.780023	780 x 10 x 2,3	23,39	16.123123	1230 x 10 x 2,3	36,30
16.360023	360 x 10 x 2,3	10,74	16.790023	790 x 10 x 2,3	23,90	16.124123	1240 x 10 x 2,3	36,81
16.370023	370 x 10 x 2,3	10,98	16.800023	800 x 10 x 2,3	24,16	16.125123	1250 x 10 x 2,3	37,32
16.380.023	380 x 10 x 2,3	11,12	16.810023	810 x 10 x 2,3	24,41	16.126123	1260 x 10 x 2,3	37,58
16.390.023	390 x 10 x 2,3	11,38	16.820023	820 x 10 x 2,3	24,67	16.127123	1270 x 10 x 2,3	37,84
16.400.023	400 x 10 x 2,3	11,76	16.830023	830 x 10 x 2,3	25,05	16.128123	1280 x 10 x 2,3	38,09
16.410.023	410 x 10 x 2,3	12,14	16.840023	840 x 10 x 2,3	25,44	16.129123	1290 x 10 x 2,3	38,35
16.420.023	420 x 10 x 2,3	12,27	16.850023	850 x 10 x 2,3	25,56	16.130123	1300 x 10 x 2,3	38,60
16.430.023	430 x 10 x 2,3	12,40	16.860023	860 x 10 x 2,3	26,08	16.131123	1310 x 10 x 2,3	38,88
16.440.023	440 x 10 x 2,3	12,65	16.870023	870 x 10 x 2,3	26,33	16.132123	1320 x 10 x 2,3	39,11
16.450.023	450 x 10 x 2,3	13,04	16.880023	880 x 10 x 2,3	26,50	16.133123	1330 x 10 x 2,3	39,37
16.460.023	460 x 10 x 2,3	13,42	16.890023	890 x 10 x 2,3	26,84	16.134123	1340 x 10 x 2,3	39,88
16.470.023	470 x 10 x 2,3	13,68	16.900023	900 x 10 x 2,3	27,10	16.135123	1350 x 10 x 2,3	40,39

Andere Abmessungen auf Anfrage

Unverbindliche Preisempfehlung · Alle Preise verstehen sich als Verkaufspreise zuzüglich der aktuellen gesetzlichen Mehrwertsteuer · Änderungen vorbehalten

Centro Lock Hobelmesser

HS-Qualität für Weich- und Hartholz

Bestell-Nr.	Maße in mm	€/Stück
17.020302	20 x 16 x 3,0	5,25
17.060302	60 x 16 x 3,0	7,40
17.100302	100 x 16 x 3,0	10,92
17.130302	130 x 16 x 3,0	12,65
17.150302	150 x 16 x 3,0	13,76
17.170302	170 x 16 x 3,0	13,91
17.180302	180 x 16 x 3,0	14,86
17.190302	190 x 16 x 3,0	15,91
17.230302	230 x 16 x 3,0	16,91
17.240302	240 x 16 x 3,0	17,27
17.260302	260 x 16 x 3,0	18,01
17.270302	270 x 16 x 3,0	19,06
17.460302	460 x 16 x 3,0	32,87

HW-Qualität für Harthölzer, verleimte Hölzer und MDF-Platten

Bestell-Nr.	Maße in mm	€/Stück
18.020302	20 x 16 x 3,0	14,72
18.060302	60 x 16 x 3,0	23,09
18.100302	100 x 16 x 3,0	32,55
18.130302	130 x 16 x 3,0	39,83
18.150302	150 x 16 x 3,0	45,14
18.170302	170 x 16 x 3,0	51,38
18.180302	180 x 16 x 3,0	54,50
18.190302	190 x 16 x 3,0	56,58
18.230302	230 x 16 x 3,0	68,12
18.240302	240 x 16 x 3,0	71,24
18.260302	260 x 16 x 3,0	76,54
18.270302	270 x 16 x 3,0	79,66
18.460302	460 x 16 x 3,0	137,28

CentroStar/CentroFix/QuickFix-Hobelmesser · System LEITZ

HS-Qualität im Set von 4 Stück (* im Set von 3 Stück)

Bestell-Nr.	Maße in mm	€/Stück
19.100027	100 x 12 x 2,7	60,38
19.120027	120 x 12 x 2,7	65,31
19.124027	124 x 12 x 2,7	64,68
19.130027	130 x 12 x 2,7	63,21
19.136027	136 x 12 x 2,7	65,84
19.150027	150 x 12 x 2,7	65,84
19.170027	170 x 12 x 2,7	71,40
19.180027	180 x 12 x 2,7	71,40
19.186027*	186 x 12 x 2,7	55,02
19.190027	190 x 12 x 2,7	74,45
19.210027	210 x 12 x 2,7	74,45
19.230027	230 x 12 x 2,7	84,21
19.240027	240 x 12 x 2,7	94,61
19.260027	260 x 12 x 2,7	94,61
19.310027	310 x 12 x 2,7	107,10
19.400027	400 x 12 x 2,7	122,85
19.410027	410 x 12 x 2,7	124,95
19.411027*	410 x 12 x 2,7	95,13
19.420027	420 x 12 x 2,7	128,10
19.430027	430 x 12 x 2,7	130,73
19.500027	500 x 12 x 2,7	152,25
19.510027	510 x 12 x 2,7	153,30
19.520027	520 x 12 x 2,7	156,45
19.530027	530 x 12 x 2,7	160,65
19.540027	540 x 12 x 2,7	162,75
19.610027	610 x 12 x 2,7	182,18
19.630027	630 x 12 x 2,7	191,10
19.640027	640 x 12 x 2,7	191,10
19.710027	710 x 12 x 2,7	208,95
19.810027	810 x 12 x 2,7	240,45

HW-Qualität im Set von 2 Stück (* 1 Stück)

Bestell-Nr.	Maße in mm	€/Stück
20.100027	100 x 12 x 2,7	85,70
20.120027	120 x 12 x 2,7	92,35
20.130027	130 x 12 x 2,7	100,98
20.136027	136 x 12 x 2,7	103,48
20.150027	150 x 12 x 2,7	103,48
20.170027	170 x 12 x 2,7	112,84
20.180027	180 x 12 x 2,7	112,84
20.190027	190 x 12 x 2,7	120,12
20.210027	210 x 12 x 2,7	125,84
20.230027	230 x 12 x 2,7	120,12
20.240027	240 x 12 x 2,7	139,88
20.400027*	400 x 12 x 2,7	115,44
20.410027*	410 x 12 x 2,7	118,56
20.420027*	420 x 12 x 2,7	120,64
20.430027*	430 x 12 x 2,7	122,72
20.500027*	500 x 12 x 2,7	146,64
20.510027*	510 x 12 x 2,7	148,72
20.520027*	520 x 12 x 2,7	151,32
20.530027*	530 x 12 x 2,7	152,88
20.540027*	540 x 12 x 2,7	154,96

Einweg-Hobelmesser zum Wenden

für Messerköpfe, Abricht- und Dicktenhobelmaschinen, Heimwerkermaschinen etc. – Träger Solidur

Bestell-Nr.	Länge in mm	€/Stück	Bestell-Nr.	Länge in mm	€/Stück	Bestell-Nr.	Länge in mm	€/Stück
21.040015	40	6,06	21.240015	240	10,67	21.560015	560	23,79
21.050015	50	6,28	21.245015	245	10,67	21.590015	590	30,88
21.052015	52	6,46	21.250015	250	11,10	21.600015	600	31,81
21.060015	60	6,46	21.260015	260	11,58	21.610015	610	32,05
21.080015	80	7,39	21.263015	263	12,01	21.620015	620	32,35
21.090015	90	7,39	21.300015	300	12,01	21.630015	630	32,35
21.100015	100	7,39	21.305015	305	12,34	21.640015	640	32,62
21.105015	105	7,76	21.310015	310	12,34	21.650015	650	33,20
21.110015	110	7,76	21.320015	320	12,56	21.660015	660	33,20
21.115015	115	7,87	21.330015	330	12,67	21.700015	700	34,76
21.120015	120	7,87	21.350015	350	13,23	21.710015	710	35,20
21.125015	125	7,87	21.360015	360	13,34	21.740015	740	35,72
21.130015	130	8,15	21.400015	400	14,34	21.760015	760	35,98
21.140015	140	8,43	21.410015	410	14,62	21.800015	800	36,56
21.150015	150	8,45	21.420015	420	14,88	21.810015	810	36,56
21.160015	160	9,02	21.430015	430	14,91	21.850015	850	37,98
21.170015	170	9,02	21.450015	450	15,47	21.860015	860	37,98
21.180015	180	9,27	21.460015	460	15,73	21.870015	870	37,98
21.190015	190	9,56	21.500015	500	16,58	21.100115	1000	39,11
21.200015	200	9,74	21.510015	510	16,89	21.101115	1010	39,33
21.210015	210	9,91	21.515015	515	17,11	21.103115	1030	39,24
21.220015	220	10,12	21.520015	520	17,11	21.105115	1050	39,35
21.225015	225	10,43	21.530015	530	17,27	21.128115	1280	46,39
21.230015	230	10,43	21.550015	550	19,71	21.132115	1320	47,78

Einweg-Hobelmesser zum Wenden

für Messerköpfe, Abricht- und Dicktenhobelmaschinen, Heimwerkermaschinen etc. – **Wende-Messer conaxa Standard**

Bestell-Nr.	Länge in mm	€/Stück	Bestell-Nr.	Länge in mm	€/Stück	Bestell-Nr.	Länge in mm	€/Stück
22.040015	40	1,29	22.240015	240	6,59	22.560015	560	15,54
22.050015	50	1,57	22.245015	245	6,59	22.590015	590	15,54
22.052015	52	1,57	22.250015	250	6,59	22.600015	600	15,54
22.060015	60	1,87	22.260015	260	6,91	22.610015	610	15,85
22.080015	80	2,50	22.263015	263	7,03	22.620015	620	15,99
22.090015	90	2,64	22.300015	300	7,88	22.630015	630	16,31
22.100015	100	2,98	22.305015	305	8,00	22.640015	640	16,49
22.105015	105	3,12	22.310015	310	8,24	22.650015	650	17,12
22.110015	110	3,32	22.320015	320	8,51	22.660015	660	17,12
22.115015	115	3,47	22.330015	330	8,78	22.700015	700	18,06
22.120015	120	3,47	22.350015	350	9,28	22.710015	710	18,23
22.125015	125	3,47	22.360015	360	9,28	22.740015	740	18,87
22.130015	130	3,78	22.400015	400	10,47	22.760015	760	19,23
22.140015	140	3,91	22.410015	410	10,67	22.800015	800	20,50
22.150015	150	4,09	22.420015	420	10,98	22.810015	810	20,92
22.160015	160	4,75	22.430015	430	11,30	22.850015	850	21,79
22.170015	170	4,75	22.450015	450	11,62	22.860015	860	22,18
22.180015	180	4,99	22.460015	460	11,90	22.870015	870	23,16
22.190015	190	5,19	22.500015	500	12,24	22.100115	1000	34,18
22.200015	200	5,36	22.510015	510	12,24	22.101115	1010	34,18
22.210015	210	5,62	22.515015	515	13,17	22.103115	1030	34,18
22.220015	220	5,98	22.520015	520	13,17	22.105115	1050	35,49
22.225015	225	6,14	22.530015	530	13,75	22.128115	1280	35,49
22.230015	230	6,28	22.550015	550	14,38	22.132115	1320	37,64

Andere Abmessungen auf Anfrage

Unverbindliche Preisempfehlung · Alle Preise verstehen sich als Verkaufspreise zuzüglich der aktuellen gesetzlichen Mehrwertsteuer · Änderungen vorbehalten

Einweg-Hobelmesser zum Wenden

für Messerköpfe, Abricht- und Dicktenhobelmaschinen, Heimwerkermaschinen etc. – **Wende-Messer conaxo HS M42**

Bestell-Nr.	Länge in mm	€/Stück	Bestell-Nr.	Länge in mm	€/Stück	Bestell-Nr.	Länge in mm	€/Stück
23.040015	40	3,19	23.240015	240	15,51	23.560015	560	30,84
23.050015	50	3,60	23.245015	245	15,95	23.590015	590	33,26
23.052015	52	3,95	23.250015	250	15,95	23.600015	600	33,66
23.060015	60	3,95	23.260015	260	16,91	23.610015	610	34,40
23.080015	80	5,39	23.263015	263	17,24	23.620015	620	35,11
23.090015	90	6,02	23.300015	300	17,63	23.630015	630	35,64
23.100015	100	6,77	23.305015	305	19,55	23.640015	640	36,01
23.105015	105	7,15	23.310015	310	19,97	23.650015	650	36,01
23.110015	110	7,18	23.320015	320	20,71	23.660015	660	40,04
23.115015	115	7,93	23.330015	330	21,34	23.700015	700	39,30
23.120015	120	7,93	23.350015	350	20,02	23.710015	710	41,57
23.125015	125	7,93	23.360015	360	20,36	23.740015	740	45,28
23.130015	130	8,54	23.400015	400	21,84	23.760015	760	45,28
23.140015	140	9,37	23.410015	410	21,84	23.800015	800	47,55
23.150015	150	9,97	23.420015	420	22,84	23.810015	810	48,24
23.160015	160	11,20	23.430015	430	24,23	23.850015	850	51,21
23.170015	170	11,20	23.450015	450	25,29	23.860015	860	51,89
23.180015	180	11,58	23.460015	460	25,95	23.870015	870	65,88
23.190015	190	12,63	23.500015	500	28,18	23.100115	1000	69,81
23.200015	200	12,94	23.510015	510	28,18	23.101115	1010	72,22
23.210015	210	13,59	23.515015	515	28,92	23.103115	1030	72,22
23.220015	220	14,37	23.520015	520	29,25	23.105115	1050	71,75
23.225015	225	14,55	23.530015	530	29,63	23.128115	1280	74,77
23.230015	230	14,77	23.550015	550	30,84	23.132115	1320	78,62

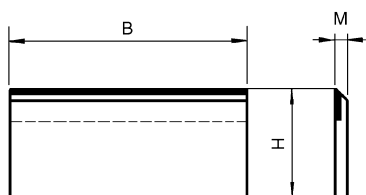

Präzisions - Streifenhobelmesser HW

Für alle Harthölzer, Pressholz, Schichtholz, Hartpapier, Hartgewebe und alle Plattenwerkstoffe

Standard-Abmessungen Lager-Programm

Bestell-Nr.	Maße in mm	Bestell-Nr.	Maße in mm	€/Stück
24.060030	60 x 30 x 3	24.060035	60 x 35 x 3	23,00
24.080030	80 x 30 x 3	24.080035	80 x 35 x 3	29,00
24.100030	100 x 30 x 3	24.100035	100 x 35 x 3	34,00
24.110030	110 x 30 x 3	24.110035	110 x 35 x 3	37,00
24.120030	120 x 30 x 3	24.120035	120 x 35 x 3	42,00
24.130030	130 x 30 x 3	24.130035	130 x 35 x 3	45,00
24.140030	140 x 30 x 3	24.140035	140 x 35 x 3	46,00
24.150030	150 x 30 x 3	24.150035	150 x 35 x 3	50,00
24.160030	160 x 30 x 3	24.160035	160 x 35 x 3	54,00
24.170030	170 x 30 x 3	24.170035	170 x 35 x 3	57,00
24.180030	180 x 30 x 3	24.180035	180 x 35 x 3	61,00
24.200030	200 x 30 x 3	24.200035	200 x 35 x 3	67,00
24.210030	210 x 30 x 3	24.210035	210 x 35 x 3	70,00
24.230030	230 x 30 x 3	24.230035	230 x 35 x 3	76,00
24.250030	250 x 30 x 3	24.250035	250 x 35 x 3	83,00
24.260030	260 x 30 x 3	24.260035	260 x 35 x 3	85,00
24.300030	300 x 30 x 3	24.300035	300 x 35 x 3	96,00
24.310030	310 x 30 x 3	24.310035	310 x 35 x 3	100,00
24.350030	350 x 30 x 3	24.350035	350 x 35 x 3	112,00
24.400030	400 x 30 x 3	24.400035	400 x 35 x 3	127,00
24.410030	410 x 30 x 3	24.410035	410 x 35 x 3	131,00
24.450030	450 x 30 x 3	24.450035	450 x 35 x 3	143,00
24.500030	500 x 30 x 3	24.500035	500 x 35 x 3	160,00
24.510030	510 x 30 x 3	24.510035	510 x 35 x 3	162,00
24.600030	600 x 30 x 3	24.600035	600 x 35 x 3	190,00
24.610030	610 x 30 x 3	24.610035	610 x 35 x 3	192,00
24.630030	630 x 30 x 3	24.630035	630 x 35 x 3	197,00
24.640030	640 x 30 x 3	24.640035	640 x 35 x 3	199,00
24.710030	710 x 30 x 3	24.710035	710 x 35 x 3	221,00
24.810030	810 x 30 x 3	24.810035	810 x 35 x 3	250,00
24.860030	860 x 30 x 3	24.860035	860 x 35 x 3	270,00

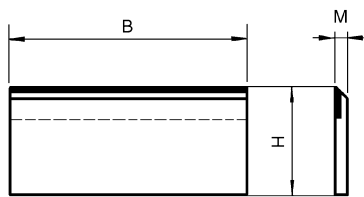

Präzisions - Streifenhobelmesser HS

Maschinell plan- und scharfgeschliffen

Für Naturholz weich bis hart

Unsere HS-Messer werden aus bester Dmo-5-Legierung hergestellt

Standard-Abmessungen Lager-Programm

Bestell-Nr.	Maße in mm	Bestell-Nr.	Maße in mm	€/Stück
25.100030	100 x 30 x 3	25.100035	100 x 35 x 3	10,80
25.130030	130 x 30 x 3	25.130035	130 x 35 x 3	10,80
25.150030	150 x 30 x 3	25.150035	150 x 35 x 3	12,80
25.160030	160 x 30 x 3	25.160035	160 x 35 x 3	13,40
25.170030	170 x 30 x 3	25.170035	170 x 35 x 3	14,30
25.180030	180 x 30 x 3	25.180035	180 x 35 x 3	15,10
25.210030	210 x 30 x 3	25.210035	210 x 35 x 3	16,40
25.230030	230 x 30 x 3	25.230035	230 x 35 x 3	17,70
25.260030	260 x 30 x 3	25.260035	260 x 35 x 3	21,00
25.300030	300 x 30 x 3	25.300035	300 x 35 x 3	23,00
25.310030	310 x 30 x 3	25.310035	310 x 35 x 3	24,70
25.350030	350 x 30 x 3	25.350035	350 x 35 x 3	27,80
25.400030	400 x 30 x 3	25.400035	400 x 35 x 3	31,00
25.410030	410 x 30 x 3	25.410035	410 x 35 x 3	31,50
25.450030	450 x 30 x 3	25.450035	450 x 35 x 3	36,00
25.500030	510 x 30 x 3	25.500035	500 x 35 x 3	39,00
25.510030	510 x 30 x 3	25.510035	510 x 35 x 3	39,70
25.530030	530 x 30 x 3	25.530035	530 x 35 x 3	43,50
25.600030	600 x 30 x 3	25.600035	600 x 35 x 3	48,00
25.610030	610 x 30 x 3	25.610035	610 x 35 x 3	48,00
25.630030	630 x 30 x 3	25.630035	630 x 35 x 3	50,00
25.640030	640 x 30 x 3	25.640035	640 x 35 x 3	50,50
25.710030	710 x 30 x 3	25.710035	710 x 35 x 3	55,00
25.810030	810 x 30 x 3	25.810035	810 x 35 x 3	63,50

Wendemesser

für Einsatz in **TERMINUS**-Werkzeugen der Typen 9000 – 9500

Aufgrund des Querschnitts mehrfach nachschleifbar.

HSS 18% (für Typ 9600)

Bestell-Nr.	Länge in mm	€/Stück
26.9600050	50	7,45
26.9600060	60	7,75
26.9600080	80	9,05
26.9600100	100	9,70
26.9600110	110	10,05
26.9600120	120	10,35
26.9600130	130	10,65
26.9600140	140	11,00
26.9600150	150	11,95
26.9600160	160	12,60
26.9600170	170	13,25
26.9600180	180	13,90
26.9600190	190	14,55
26.9600200	200	15,15
26.9600210	210	15,85
26.9600220	220	16,50
26.9600230	230	17,10
26.9600240	240	18,10
26.9600250	250	18,70
26.9600260	260	19,40
26.9600270	270	20,05
26.9600280	280	20,65
26.9600300	300	21,95
26.9600310	310	23,25
26.9600350	350	24,55
26.9600360	360	24,85
26.9600400	400	25,15
26.9600410	410	25,85
26.9600420	420	26,50
26.9600430	430	27,15
26.9600450	450	28,40
26.9600510	510	31,65
26.9600520	520	32,30
26.9600530	530	32,95
26.9600610	610	38,40
26.9600620	620	39,10
26.9600630	630	39,70
26.9600640	640	40,35
26.9600650	650	41,00
26.9600660	660	41,65
26.9600800	800	45,85

HM (für Typ 9640)

Bestell-Nr.	Länge in mm	€/Stück
26.9640050	50	20,60
26.9640060	60	23,80
26.9640080	80	29,90
26.9640100	100	36,10
26.9640110	110	39,25
26.9640120	120	42,35
26.9640130	130	45,35
26.9640140	140	48,45
26.9640150	150	51,55
26.9640160	160	54,70
26.9640170	170	57,80
26.9640180	180	60,80
26.9640190	190	63,90
26.9640200	200	67,00
26.9640210	210	70,20
26.9640220	220	73,25
26.9640230	230	76,30
26.9640240	240	79,45
26.9640250	250	82,45
26.9640260	260	85,65
26.9640270	270	88,70
26.9640280	280	91,80
26.9640300	300	97,90
26.9640310	310	101,10
26.9640350	350	113,35
26.9640360	360	116,60
26.9640400	400	128,85
26.9640410	410	132,05
26.9640420	420	135,10
26.9640430	430	138,20
26.9640450	450	144,30
26.9640510	510	162,95
26.9640520	520	166,05
26.9640530	530	169,15
26.9640610	610	193,85
26.9640620	620	196,95
26.9640630	630	200,10
26.9640640	640	203,20
26.9640650	650	206,15
26.9640660	660	209,35
26.9640800	800	248,80

HSS-ULTRA-HPC (für Typ 9670)

Bestell-Nr.	Länge in mm	€/Stück
26.9670050	50	10,95
26.9670060	60	12,25
26.9670080	80	14,85
26.9670100	100	17,40
26.9670110	110	18,70
26.9670120	120	20,00
26.9670130	130	21,30
26.9670140	140	22,60
26.9670150	150	23,90
26.9670160	160	25,15
26.9670170	170	26,45
26.9670180	180	27,75
26.9670190	190	28,95
26.9670200	200	30,25
26.9670210	210	31,55
26.9670220	220	32,85
26.9670230	230	34,15
26.9670240	240	35,45
26.9670250	250	36,70
26.9670260	260	38,00
26.9670270	270	39,30
26.9670280	280	40,60
26.9670300	300	43,10
26.9670310	310	44,50
26.9670350	350	49,65
26.9670360	360	50,95
26.9670400	400	56,05
26.9670410	410	57,35
26.9670420	420	58,60
26.9670430	430	59,90
26.9670450	450	62,50
26.9670510	510	70,25
26.9670520	520	71,55
26.9670530	530	72,85
26.9670610	610	83,10
26.9670620	620	84,40
26.9670630	630	85,70
26.9670640	640	87,00
26.9670650	650	88,30
26.9670660	660	89,55
26.9670800	800	105,35

HS/HM-Profilmesser

HS-Messer für Profiltiefe bis max. 12,7 mm

Einsetzbar in den **TERMINUS**-Typenreihen 9100 und 9300

Profile bis 230 mm und 12,7 mm Profiltiefe auf Anfrage

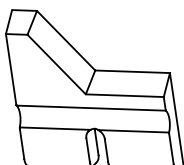
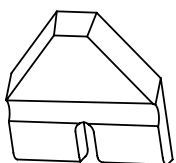
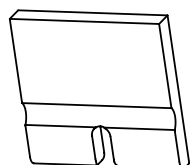

rechts

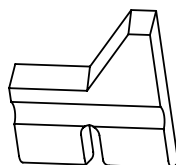

links

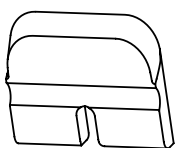
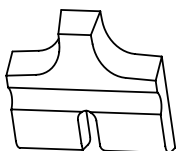

Beschreibung	HS Bestell-Nr.	€/Stück	HM Bestell-Nr.	€/Stück
Rohlinge				
Höhe	max. Tiefe			
30 mm	10,35 mm	25.9700030030	25.9741030030	31,00 66,00
32 mm	12,00 mm	25.9700030032	nicht erhältlich	31,00
34 mm	12,70 mm	25.9700030034	nicht erhältlich	31,00
Fasemesser 45°				
		25.970503045	25.970603045	42,00 88,00
Fasemesser 45° rechts				
		25.9705030451	25.9706030451	42,00 88,00
Fasemesser 45° links				
		25.9705030452	25.9706030452	42,00 88,00
Abrundmesser				
R2		25.971003002	25.971103002	42,00 88,00
R3		25.971003003	25.971103003	42,00 88,00
R4		25.971003004	25.971103004	42,00 88,00
R5		25.971003005	25.971103005	42,00 88,00
R6		25.971003006	25.971103006	42,00 88,00
R8		25.971003008	25.971103008	42,00 88,00
R10		25.971003010	nicht erhältlich	42,00
Hohlkehlmesser				
R2		25.971503002	25.971603002	46,00 88,00
R3		25.971503003	25.971603003	46,00 88,00
R4		25.971503004	25.971603004	46,00 88,00
R5		25.971503005	25.971603005	46,00 88,00
R6		25.971503006	25.971603006	46,00 88,00
R8		25.971503008	25.971603008	46,00 88,00
R10		25.971503010	nicht erhältlich	46,00

HS-Profilmesser

Für Hobelköpfe **TERMINUS**-Typenreihen 9100 und 9300

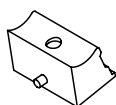
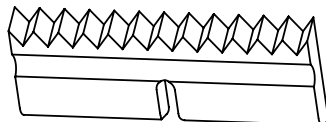
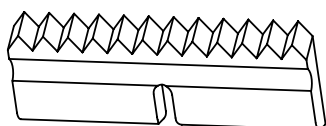
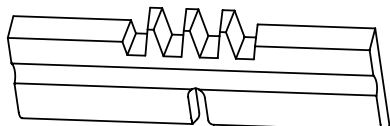
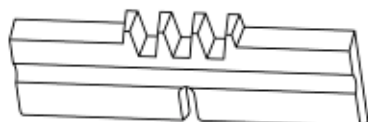
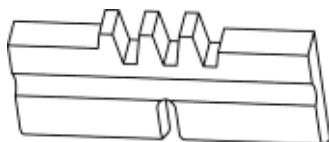
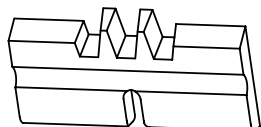
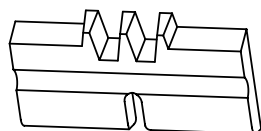

Beschreibung	HS Bestell-Nr.	€/Stück
Trapezverleimmesser 50 mm	25.97411126	71,00
Trapezverleimmesser 50 mm	25.97411127	71,00
Trapezverleimmesser 60 mm	25.97411120	79,00
Trapezverleimmesser 80 mm	25.97411124	82,00
Trapezverleimmesser 80 mm	25.97411125	82,00
Spitzverleimmesser 60 mm 80 mm	25.9750060100702 25.97411012	79,00 97,00
Spitzverleimmesser 60 mm 80 mm	25.9750060100701 25.97411011	79,00 97,00
Kippteil für Profilmesser 50 mm 60 mm 80 mm		31,00 33,00 37,00

HS-Profilmesser

Für Hobelköpfe **TERMINUS**-Typenreihen 9100 und 9300 mit flugkreis max. 105 mm

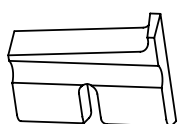
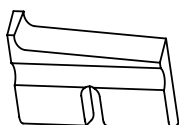
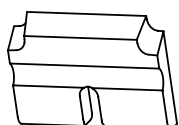
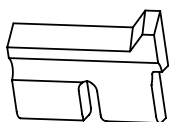
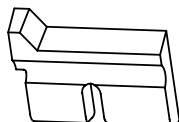
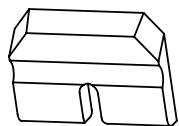

Beschreibung	HS Bestell-Nr.	€/Stück
Fasemesser 45°	25.9750030100300	42,00
Fasemesser rechts 45°	25.9750030100301	42,00
Fasemesser links 45°	25.9750030100302	42,00
Abrundmesser R2	25.9750030100402	42,00
Abrundmesser rechts R2	25.9750030100403	42,00
Abrundmesser links R2	25.9750030100404	42,00